

Recommendations



Facilities Recommendations

Overview //

The Facilities Master Plan (FMP) Recommendations for Cerritos College present an overall picture of the future developed campus and includes proposed sites for new facilities, recommendations for renovations of existing facilities, and site development projects. The recommendations described in this section address the discussion that took place during the planning process.

This chapter describes the building and the site projects identified in the FMP. The recommendations are organized into the following sections:

- Facilities Recommendations
- Site Improvement Recommendations
- Phasing

While drawings in the FMP appear specific, the forms are conceptual sketches that highlight the location and purpose of improvements. The final design of each site and facility project will take place as projects are funded and detailed programming and design occurs.

Facilities Recommendations

Facilities Planning Principles //

The FMP recommendations for Cerritos College present a model that is based on the educational planning data presented in Chapter 1 and addresses the current and projected needs through the year 2025.

Throughout the planning process, a series of facilities planning principles were developed and used to guide discussions and inspire the development of the recommendations. The following is a summary of the principles:

Maximize functional space

- Renovate facilities to address program needs.
- Address maintenance needs.

Eliminate non-functional space

- Remove temporary buildings.
- Replace inadequate/aging facilities.

Improve efficiency/utilization of site and facilities

- Cluster related programs and services.
- Create flexible, multi-purpose spaces.

Right-size the campus to address program needs

- Align facilities inventory with state guidelines.
- Position the College to maximize funding (state and local).

Develop a collegial learning environment

- Provide comfortable, shaded gathering spaces for students.
- Provide outdoor and indoor zones that facilitate collegial collaboration and learning.

Improve campus identity, connections, and circulation

- Develop campus edges and identity.
- Define clear, inviting campus entry points.
- Promote clear and safe vehicular movement and drop-offs.

Simplify implementation

- Limit disruption to campus and programs.
- Reduce swing space costs.
- Reduce number of temporary moves.

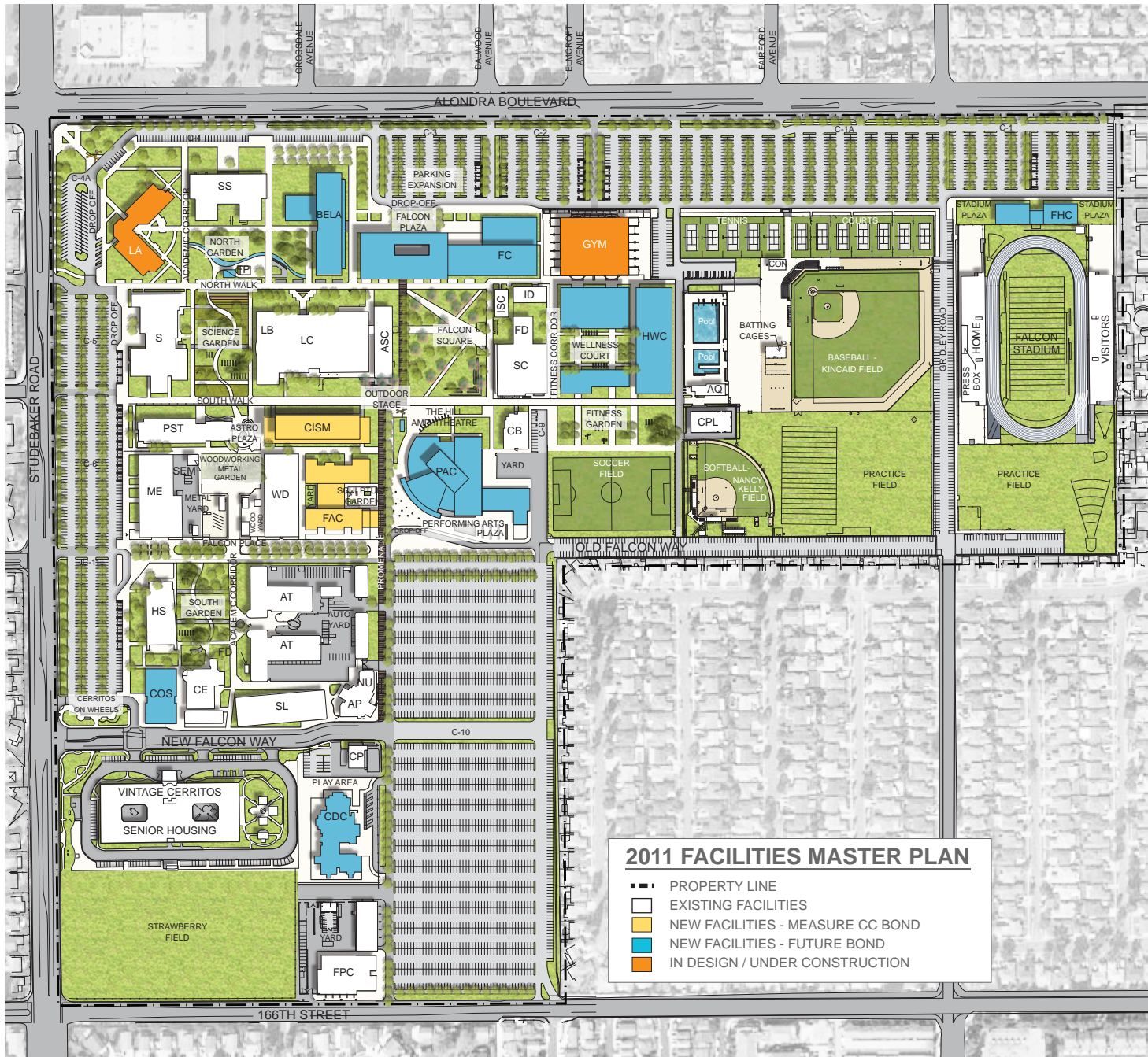

BUILDING KEY

- AD Administration
- ASC Academic Support Center
- AQ Aquatics Center
- AP Automotive Partners
- AT Automotive Technology
- CB Classroom Building
- CE Community Education
- CON Concessions
- CP Campus Police
- CPL Central Plant
- FD Food Court
- FPC Facilities & Purchasing Complex
- GYM Gymnasium
- HS Health Science
- ID Student ID Center
- ISC Instructional Support Center (DSP&S)
- LA Liberal Arts
- LB Library
- LC Learning Resource Center
- ME Metals
- NU Northwood University
- PST Physical Science Technology
- S Science
- SC Student Center
- SL Skills Lab
- SS Social Science
- SEM SEM Storage
- WD Wood Manufacturing Technology

- BELA Business Education/Language Arts
- CDC Child Development Center
- CISM CIS/Mathematics
- COS Cosmetology
- FAC Fine Arts Center
- FC Falcon Center
- FHC Field House Complex
- FP Food Pavilion
- HWC Health Wellness Complex
- PAC Performing Arts Center

2011 FACILITIES MASTER PLAN

- PROPERTY LINE
- EXISTING FACILITIES
- NEW FACILITIES - MEASURE CC BOND
- NEW FACILITIES - FUTURE BOND
- IN DESIGN / UNDER CONSTRUCTION

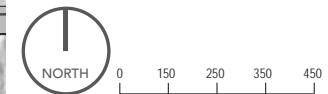

Facilities Recommendations

Demolition/Removal //

The recommendations for buildings to be demolished or removed are highlighted and described on the opposite page.

The FMP recommends the demolition/removal of the following buildings:

- Administration (Career Services, Student Services Center, EOPS, International Students)
- Bookstore (Student Activities)
- Burnight Center/Theatre
- Business Education
- Field House
- Fine Arts
- Liberal Arts
- Physical Education
- Physical Sciences
- Public Affairs (Cerritos College Foundation)
- Purchasing/Warehouse and Facilities
- Santa Barbara (DSP&S)
- Student Health & Wellness
- Technology (Child Development Center and Research and Development)
- Weight Training

- 1 Physical Education (PE)
- 2 Burnight Center/Theatre (BC)
- 3 Fine Arts (FA)
- 4 Business Education (BE)



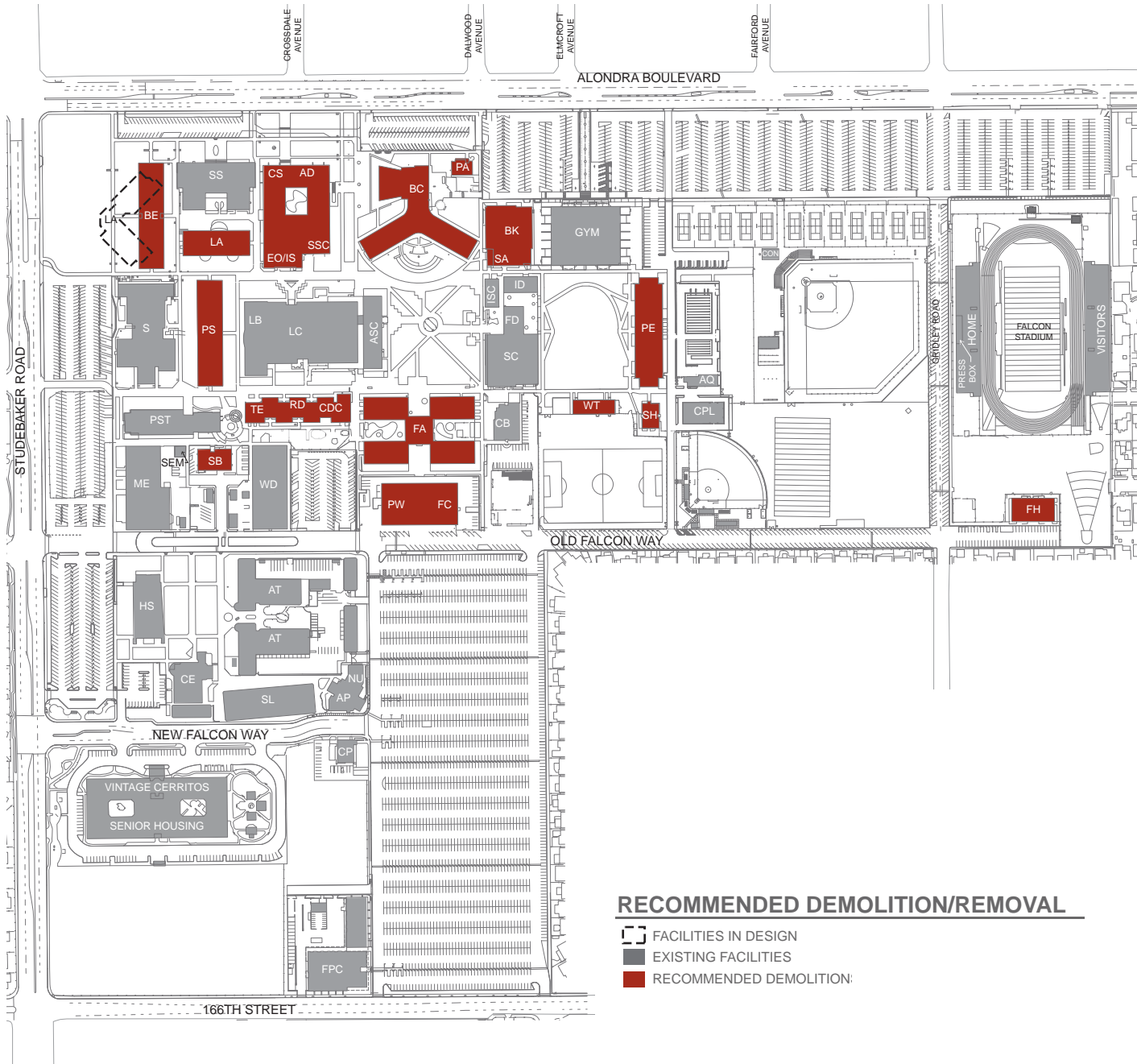

BUILDING KEY

AD	Administration
ASC	Academic Support Center
AQ	Aquatics Center
AP	Automotive Partners
AT	Automotive Technology
BC	Burnight Center/Theatre
BE	Business Education
BK	Bookstore
CB	Classroom Building
CDC	Child Development Center
CE	Community Education
CON	Concessions
CP	Campus Police
CPL	Central Plant
CS	Career Services
EO/IS	EOPS / International Students
FA	Fine Arts
FC	Facilities
FD	Food Court
FH	Field House
FPC	Facilities & Purchasing Complex
GYM	Gymnasium
HS	Health Science
ID	Student ID Center
ISC	Instructional Support Center (DSP&S)
LA	Liberal Arts
LB	Library
LC	Learning Resource Center
ME	Metals
NU	Northwood University
PA	Public Affairs/Cerritos College Foundation
PE	Physical Education
PS	Physical Sciences
PST	Physical Science Technology
PW	Purchasing/Warehouse
RD	Research and Development
S	Science/Project Hope
SA	Student Activities
SB	Santa Barbara (DSP&S)
SC	Student Center
SEM	Sem Storage
SH	Student Health & Wellness
SL	Skills Lab
SS	Social Science
SSC	Student Services Center
TB	Stadium Ticket Booth
TE	Technology
WD	Wood Manufacturing Technology
WT	Weight Training

RECOMMENDED DEMOLITION/REMOVAL

-  FACILITIES IN DESIGN
-  EXISTING FACILITIES
-  RECOMMENDED DEMOLITION:



0 150 250 350 450

Facilities Recommendations

Renovations and Modernizations //

Renovations

Several buildings have been identified in this FMP to receive a major renovation to accommodate the repurposing of existing space to support new program needs. Each building renovation project is listed here and highlighted on the following page, with a brief description of the FMP recommendations.

Health Science (HS)

Following the relocation of the Cosmetology Program, the vacated space will be renovated and repurposed to support the projected growth of programs currently housed in the building.

Classroom Building (CB)

With the addition of many interdisciplinary classrooms, it is recommended that the existing Classroom Building be renovated and repurposed to support the Culinary Arts program needs. The location for this expansion is ideal due to its proximity to the Student Center.

Press Box

The two story Press Box requires a renovation and upgrade to address the following issues:

- Accessibility.
- Conform to building codes.
- Need of air conditioning and ventilation.
- Replace most of finishes.

Modernizations

In addition to the buildings that have been identified for modernizations, many existing buildings on the campus require significant repairs. Although the buildings are well maintained and many are in good condition, a prudent planning process must anticipate the need for repairs and upgrades at some point in the course of the master planning horizon. Modernization work is recommended for all facilities for which a significant change in use is not planned. Through these projects, the College will accomplish the following objectives:

- Repairs and upgrades for safety and accessibility.
- Upgrades of technology systems.
- Refreshment of finishes and furniture systems.
- Upgrades for sustainability.

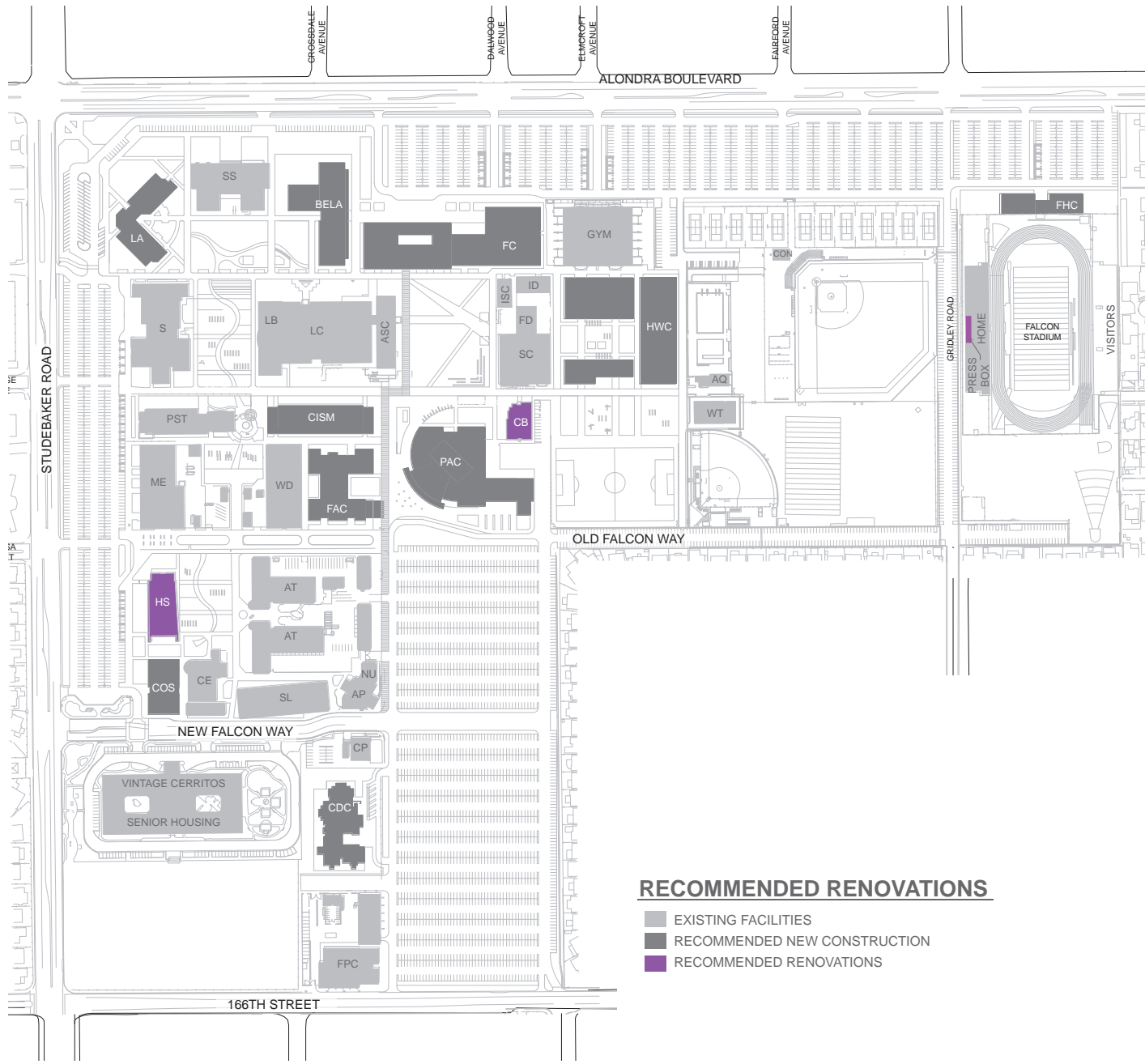

BUILDING KEY

AD	Administration
ASC	Academic Support Center
AQ	Aquatics Center
AP	Automotive Partners
AT	Automotive Technology
CB	Classroom Building
CE	Community Education
CON	Concessions
CP	Campus Police
CPL	Central Plant
FD	Food Court
FPC	Facilities & Purchasing Complex
GYM	Gymnasium
HS	Health Science
ID	Student ID Center
ISC	Instructional Support Center (DSP&S)
LA	Liberal Arts
LB	Library
LC	Learning Resource Center
ME	Metals
NU	Northwood University
PST	Physical Science Technology
S	Science
SC	Student Center
SL	Skills Lab
SS	Social Science
SEM	SEM Storage
WD	Wood Manufacturing Technology
	Press Box

BELA	Business/Language Arts
CDC	Child Development Center
CISM	CIS/Mathematics
COS	Cosmetology
FAC	Fine Arts Center
FC	Falcon Center
FHC	Field House Complex
FP	Food Pavilion
HWC	Health Wellness Complex
PAC	Performing Arts Center

RECOMMENDED RENOVATIONS

- EXISTING FACILITIES
- RECOMMENDED NEW CONSTRUCTION
- RECOMMENDED RENOVATIONS

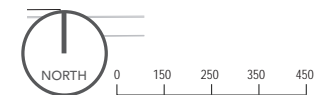

Facilities Recommendations

New Construction //

The recommended new construction projects are highlighted on the adjacent page. These projects will address the need for replacement plus additional space to accommodate the projected growth of enrollment as identified in Chapter 1. Each building provides an opportunity to create a model facility on many levels. In addition to the programmed space for instruction, these new facilities should provide informal spaces for students to meet, study, and collaborate. At this conceptual planning level, the new buildings are sited, massed, and oriented to enhance the existing campus pattern of development, work with environmental conditions, and strengthen circulation patterns.

Each new building project is listed below and described in greater detail on the following pages. The projects listed are in alphabetical order and does not imply a sequence of development.

- Business Education/Language Arts (BELA)
- Child Development Center (CDC)
- CIS/Mathematics (CISM)
- Cosmetology (COS)
- Field House Complex (FHC)
- Fine Arts Center (FAC)
- Falcon Center (FC)
- Health Wellness Complex (HMC)
- Performing Arts Center (PAC)

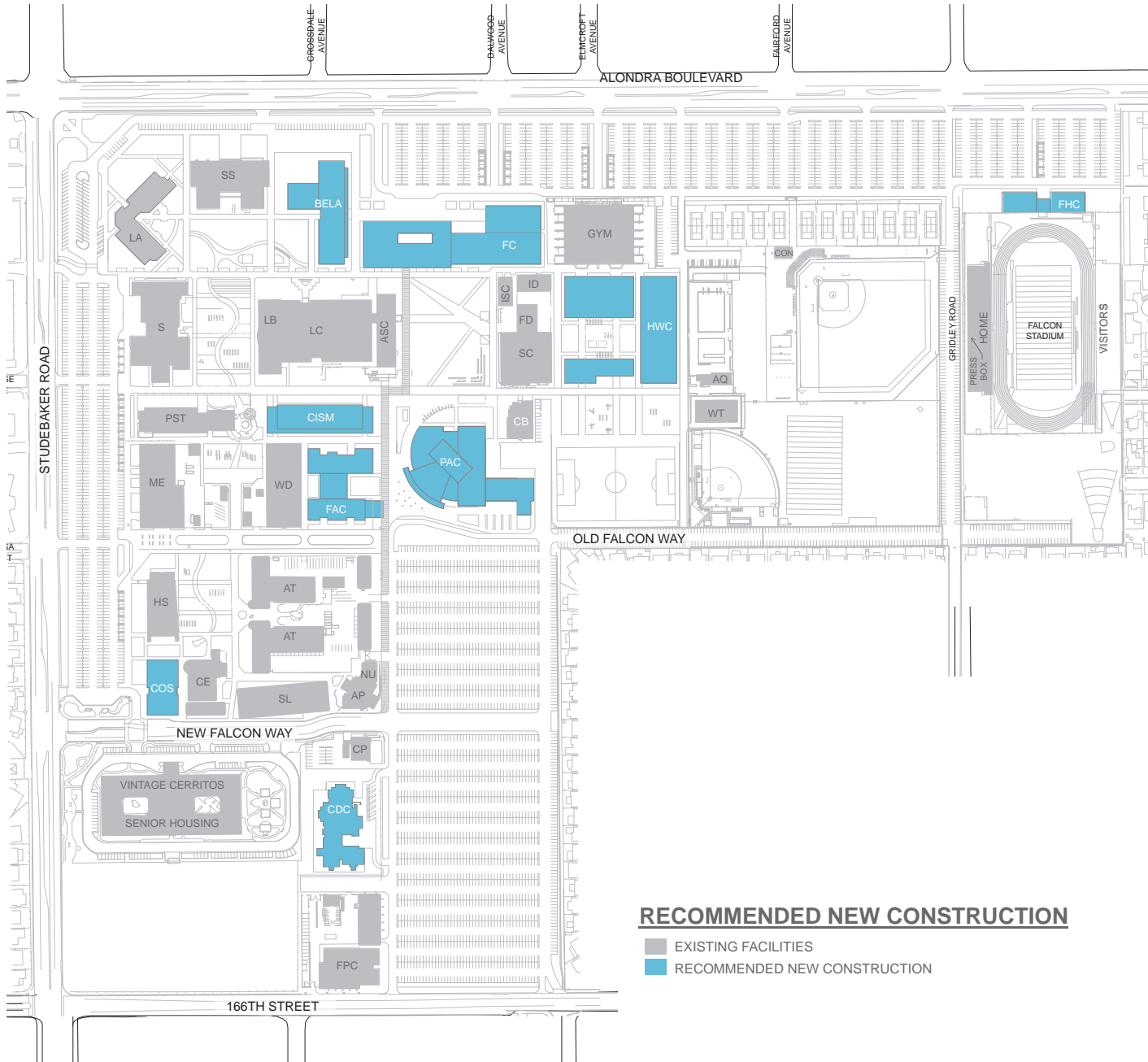

BUILDING KEY

AD	Administration
ASC	Academic Support Center
AQ	Aquatics Center
AP	Automotive Partners
AT	Automotive Technology
CB	Classroom Building
CE	Community Education
CON	Concessions
CP	Campus Police
CPL	Central Plant
FD	Food Court
FPC	Facilities & Purchasing Complex
GYM	Gymnasium
HS	Health Science
ID	Student ID Center
ISC	Instructional Support Center (DSP&S)
LA	Liberal Arts
LB	Library
LC	Learning Resource Center
ME	Metals
NU	Northwood University
PST	Physical Science Technology
S	Science
SC	Student Center
SL	Skills Lab
SS	Social Science
SEM	SEM Storage
WD	Wood Manufacturing Technology

BELA	Business/Language Arts
CDC	Child Development Center
CISM	CIS/Mathematics
COS	Cosmetology
FAC	Fine Arts Center
FC	Falcon Center
FHC	Field House Complex
FP	Food Pavilion
HWC	Health Wellness Complex
PAC	Performing Arts Center

RECOMMENDED NEW CONSTRUCTION

- EXISTING FACILITIES
- RECOMMENDED NEW CONSTRUCTION

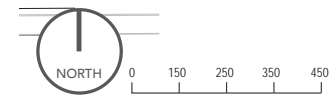





New Construction Projects

Business Education/Language Arts (BELA) //

A new Business Education/Language Arts (BELA) Building is recommended to replace aging facilities and address the projected program needs. The new building will house the Business Education and Language Arts programs of the College and will include interdisciplinary classrooms, labs, and offices. The flexible, interdisciplinary classrooms will be designed to support the entire campus and improve the efficiency/ utilization of facilities.

A placement for this new building is strategically located to support appropriate groupings with other instructional programs and frame the newly developed North Quad. This new quad will support the development of the campus as a collegial environment and create comfortable gathering spaces for students.

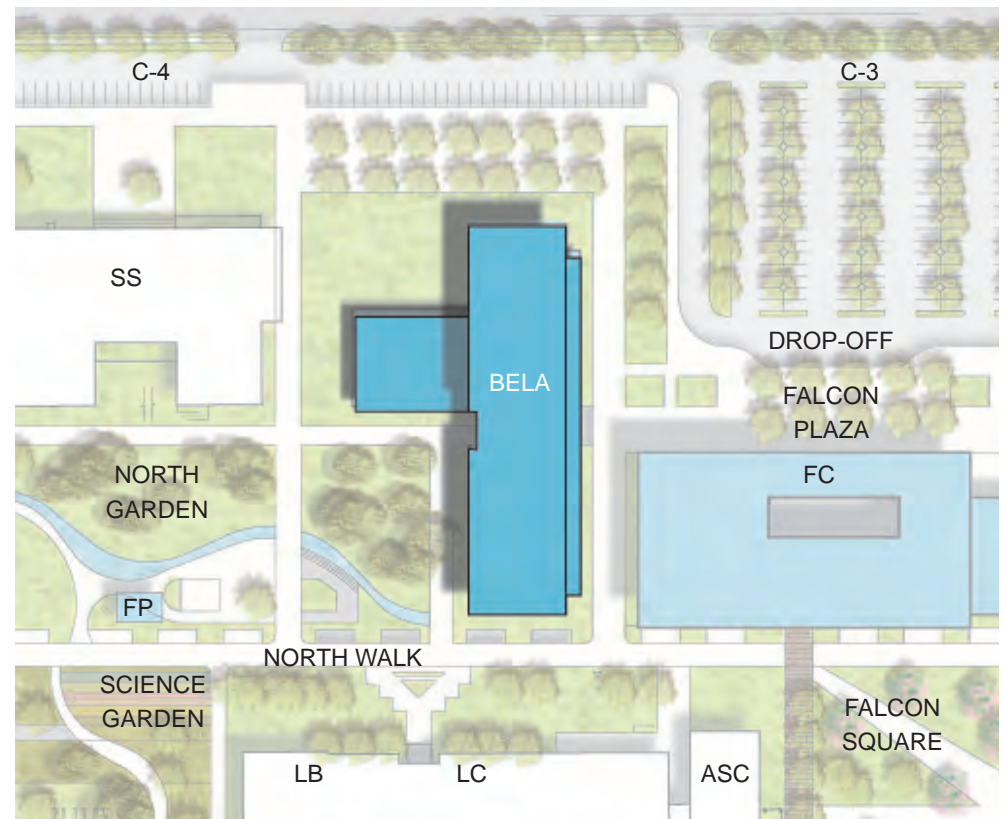



New Construction Projects

Child Development Center (CDC) //

The Child Development Center project will create a permanent site for the Child Development program on the southern side of the campus. The proposed site will be developed to include a building to support the interior program needs and a playground to address the exterior program requirements. In addition, a separate parking area will be developed to increase access to the facility.

The conceptual design included in this FMP is based on the Final Project Proposal (FPP) that was developed for the College based on a series of collaborative discussions.

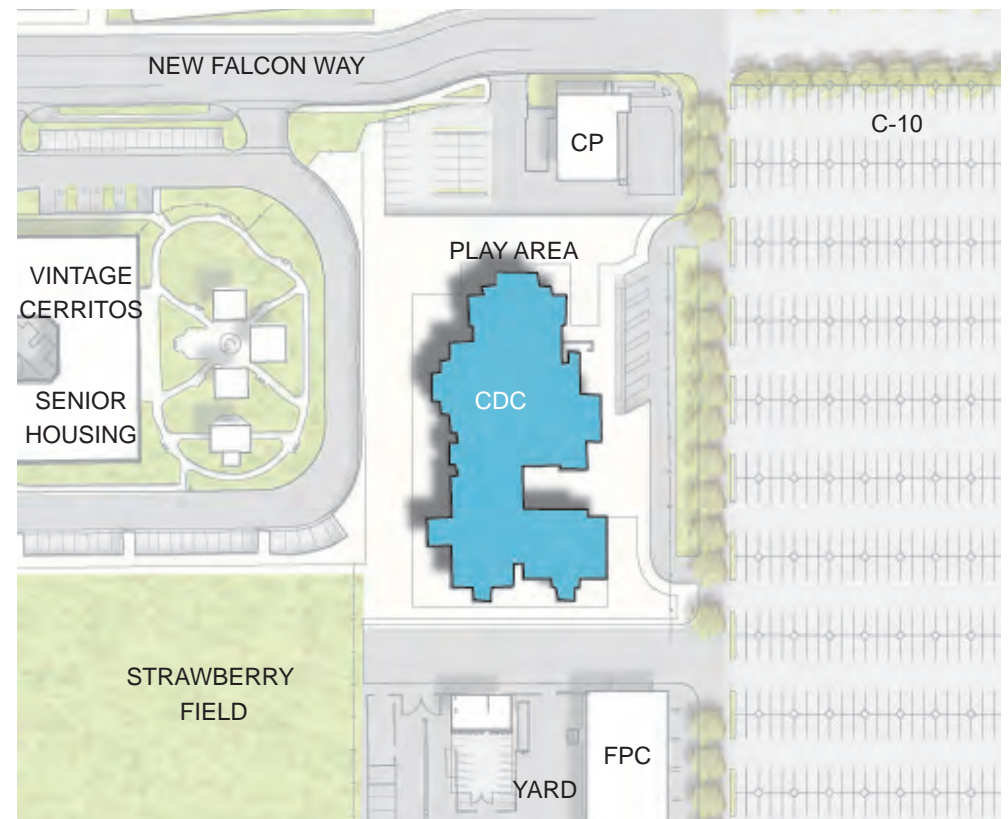



CIS/Mathematics (CISM) //

A new CIS/Mathematics Building is recommended to replace aging facilities and address the projected program needs. The new building will house the CIS and Mathematics programs of the college and will include interdisciplinary classrooms, labs, and offices. The flexible interdisciplinary classrooms will be designed to support the entire campus and improve the efficiency of facilities.

The placement of the new building provides the opportunity to link to other instructional programs, including the new Fine Arts Complex, and is adjacent to the pedestrian corridor that links to PST on the west and connects to Falcon Square on the east.

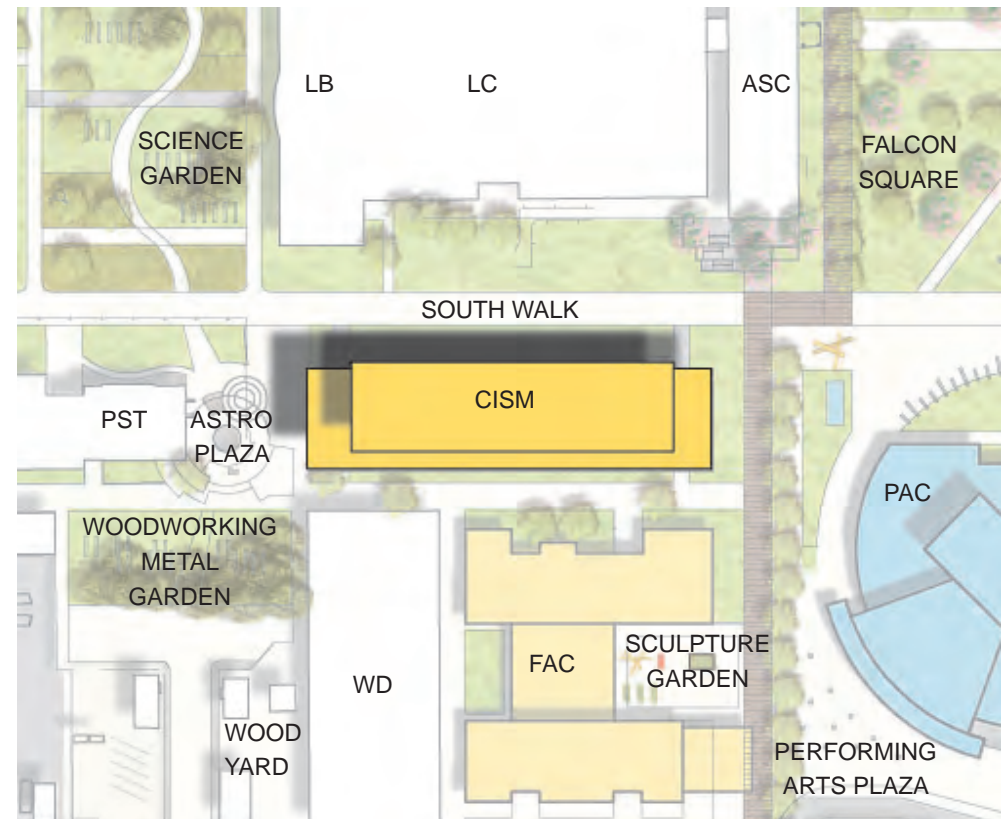



New Construction Projects

Cosmetology (COS) //

The Cosmetology Building project will create a new home for the Cosmetology program on the west side of the campus. The new building will be designed to support the unique Cosmetology program needs and will improve access for students and patrons.

The proposed site for the new building is adjacent to the Community Education Building and nearby parking, which provides the opportunity to create a strong identity for the Cosmetology program along a public edge of the campus. The FMP recommends that the design of this building and site area be developed to enhance the connection and the visibility of both the Cosmetology and Community Education Building.

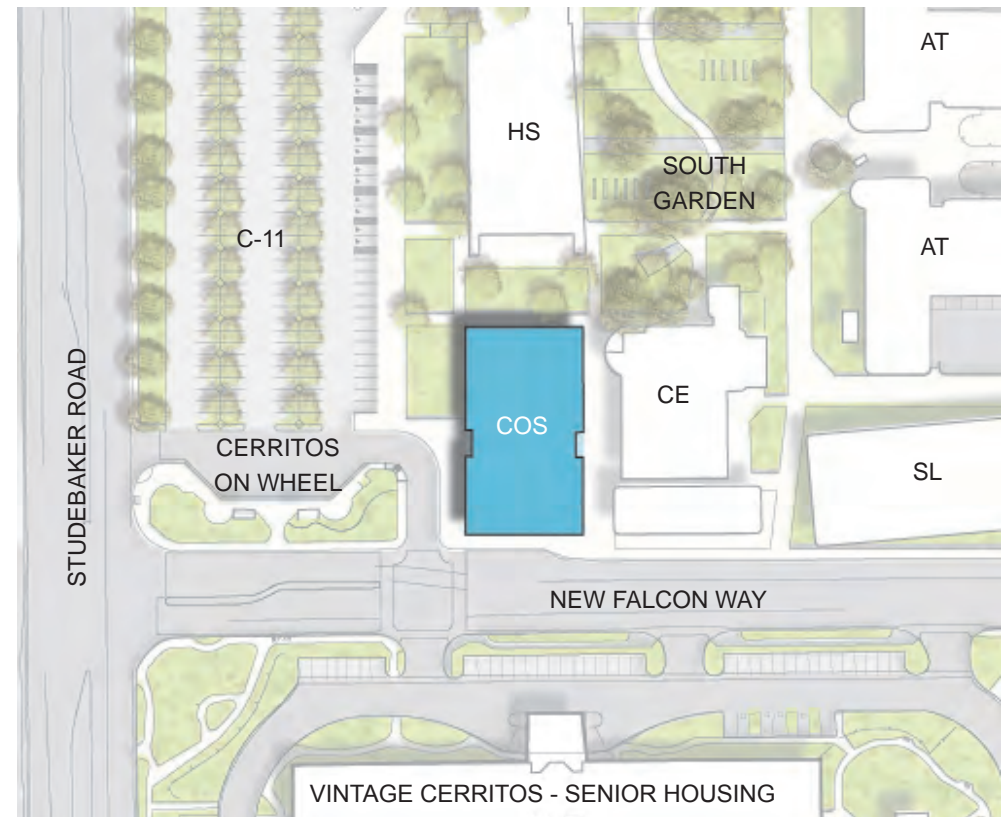



Field House Complex (FHC) //

A new Field House Complex is recommended to replace the existing aging facility and create a welcoming gateway to the stadium complex. The complex will include a ticket booth, locker rooms, team rooms, equipment storage, and restrooms to support the stadium.

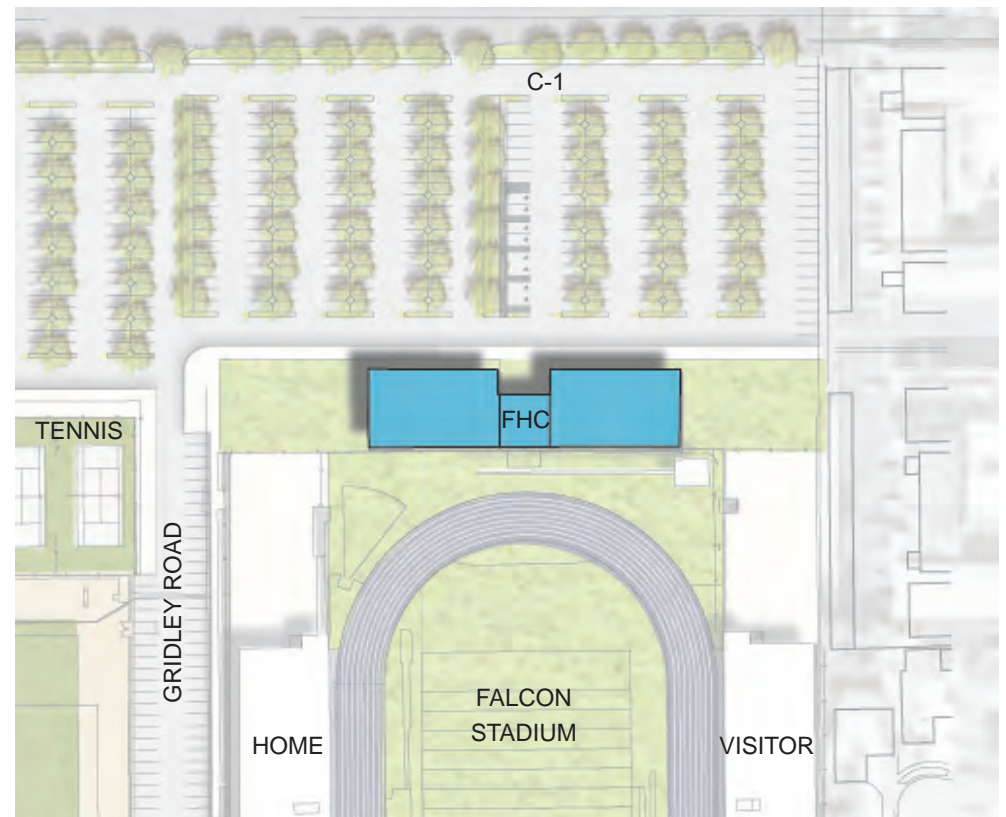



New Construction Projects

Fine Arts Center (FAC) //

The new Fine Arts Center is recommended to replace the existing aging facility and address the projected program needs. The new facility will consolidate Fine Arts instruction in the new Arts Zone of the campus, will promote interdisciplinary interaction, and will provide collaborative opportunities for students. The placement of the complex is strategically located adjacent to the proposed Performing Arts Center to support the appropriate groupings of like programs and tie into pedestrian corridors.

The conceptual design included in this FMP is based on the Final Project Proposal (FPP) that was developed for the college based on a series of collaborative discussions. It is important to note that future programming of this building and site area needs to coordinate with overall campus improvements and maintain access to the Wood Manufacturing Technology (WD) Building.

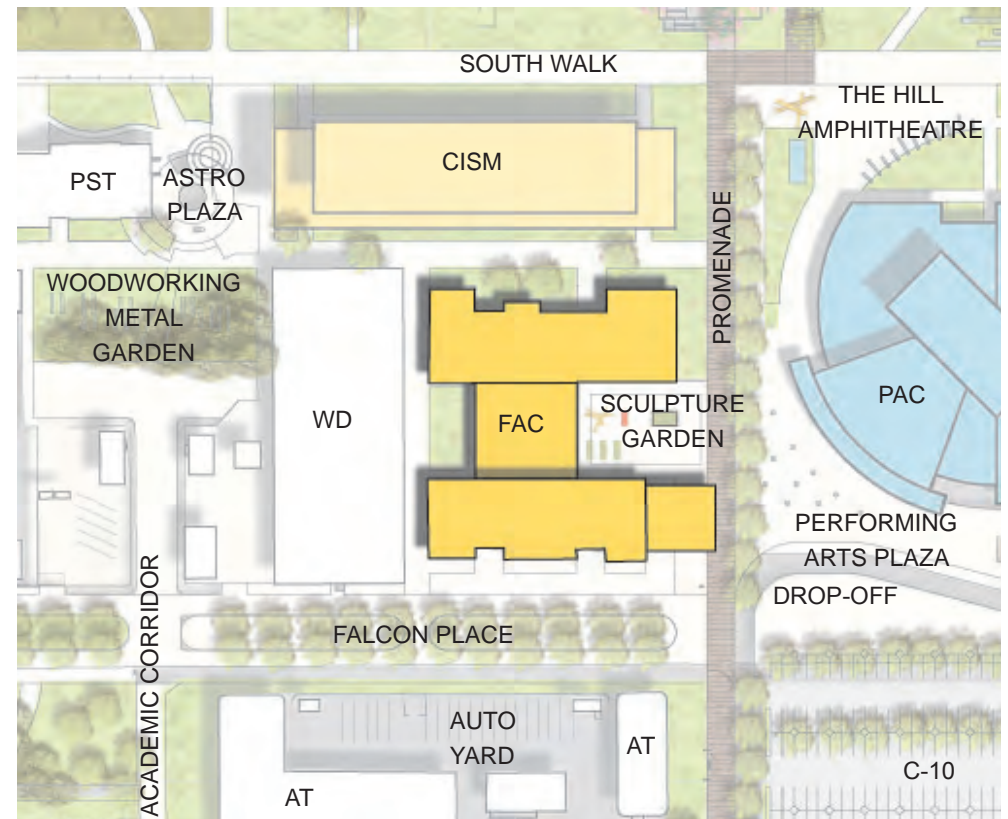



Falcon Center (FC) //

A new Falcon Center is recommended to welcome visitors to Cerritos College and create a visible “front door” to the campus. The new building will be designed to accommodate Student Services, Administration, the Bookstore, and Student Activities space. The building will increase the College’s visibility within the community and improve student access to important support services.

The proposed location of the building is set back from Alondra Boulevard providing space for expanded parking and a new drop-off. The building will provide a “window” into the campus with views through to Falcon Square and the new Performing Arts Complex.

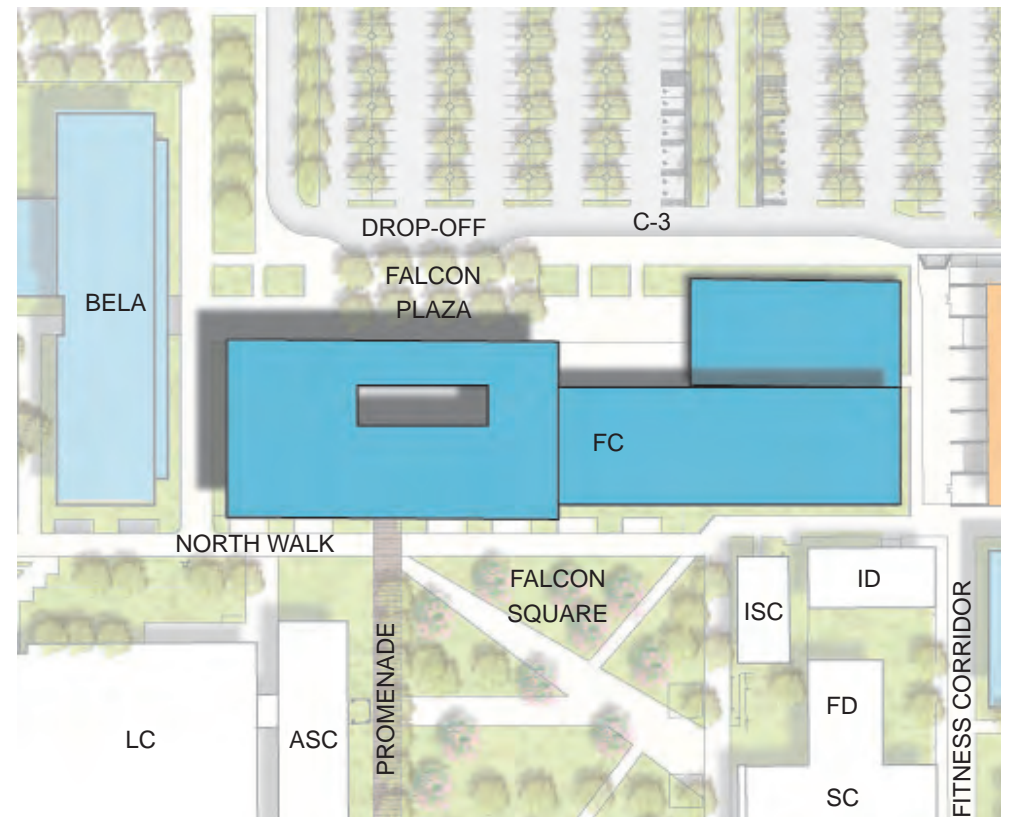



New Construction Projects

Health Wellness Complex (HWC) //

The new Health Wellness Complex is recommended to provide a facility to support the Health, PE, Athletics, and Dance Division. The complex will centralize functions that are currently dispersed around campus into an accessible, more efficient, state-of-the-art complex. The building will include fitness labs, cardio workout rooms, training rooms, multi-purpose studios, offices and the Health Center.

The location for the Health Center within the complex is recommended to be on the ground floor, on a perimeter location with two entry/exits points—one easily identifiable and one more discreet. The location will also require access for emergency vehicles.



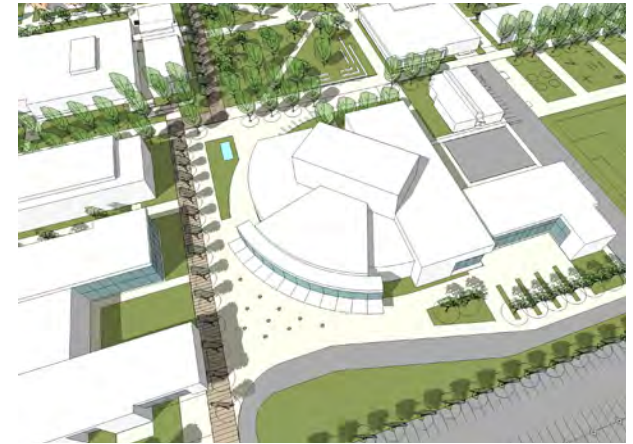

Performing Arts Center (PAC) //

The new Performing Arts Center is recommended to replace the existing aging facility and address the projected program needs. The new facility will house the Music, Theater Arts, and Radio/Television/Film instructional programs, including the new Burnight Theatre. The placement of the complex is strategically located adjacent to the proposed Fine Arts Center to support the appropriate groupings of like programs and to tie into Falcon Square activity. An outdoor performance space is recommended along the north side to spill the indoor activity to the exterior and to activate outdoor space.

The conceptual design included in this FMP is based on the Final Project Proposal (FPP) that was developed for the college based on a series of collaborative discussions.

It is important to note that future programming of this building and site area needs to be coordinated with overall campus improvements and preserve access to the Student Center (SC) Loading dock.

