



CERRITOS COLLEGE

2019 FACILITIES MASTER PLAN

CAMPUS FORUMS
April 2019



THE PROCESS

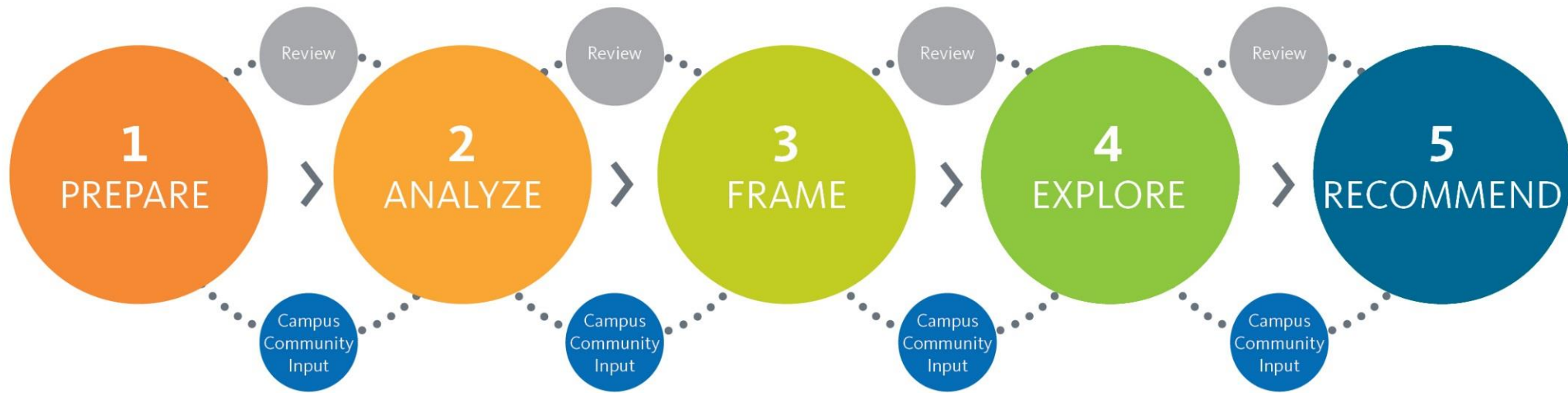

- ✓ Organize
- ✓ Schedule
- ✓ Vision

- ✓ Collect
- ✓ Assess
- ✓ Document

- ✓ Link
- ✓ Forecast
- ✓ Quantify

- ✓ Develop
- ✓ Evaluate
- ✓ Strategize

- Share
- Document
- Approve



THE TIMELINE

	2018												2019																													
	AUG				SEP				OCT				NOV				DEC				JAN				FEB				MAR				APR				MAY					
	6	13	20	27	3	10	17	24	1	8	15	22	29	5	12	19	26	3	10	17	24	31	7	14	21	28	4	11	18	25	4	11	18	25	1	8	15	22	29	6	13	20
1 PREPARE	█																																									
2 ANALYZE					█				█																																	
3 FRAME									█				█				█																									
4 EXPLORE																	█				█				█				█													
5 RECOMMEND																																	█				█					

PARTICIPATION / MEETINGS	2018												2019																																	
	AUG				SEP				OCT				NOV				DEC				JAN				FEB				MAR				APR				MAY									
	6	13	20	27	3	10	17	24	1	8	15	22	29	5	12	19	26	3	10	17	24	31	7	14	21	28	4	11	18	25	4	11	18	25	1	8	15	22	29	6	13	20	27			
FMP Subcommittee Meetings							█				█					█				█									█				█													
Division Meetings							█	█			█																																			
Campus On-Line Survey											█	█																																		
Campus Forums							█																																							
Sustainability Workshop																									█																					
Committee Meetings																																														
Board of Trustees																																														





PARTICIPATORY

CAMPUS FORUMS

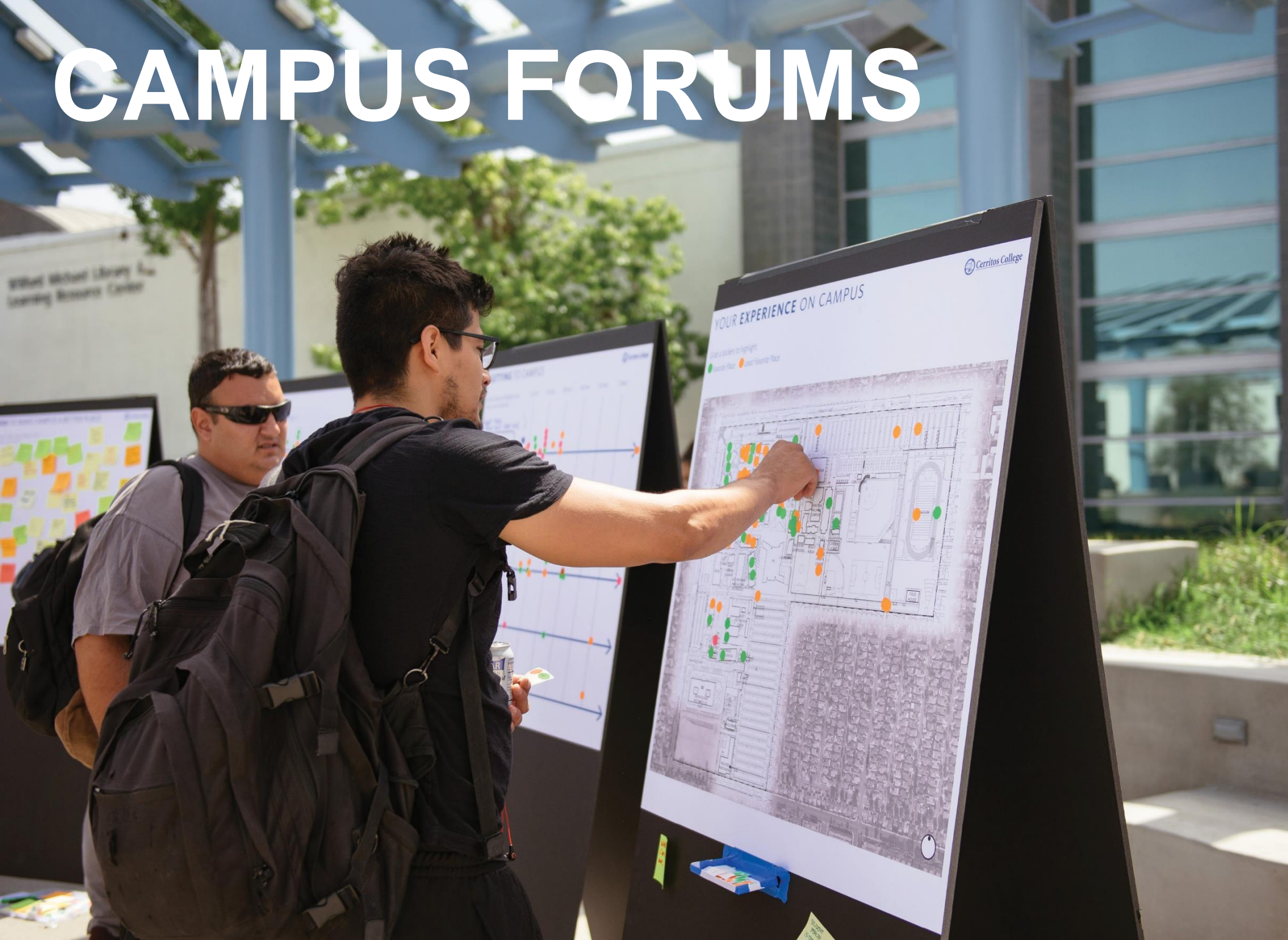

100 IDEAS

Processing Feedback

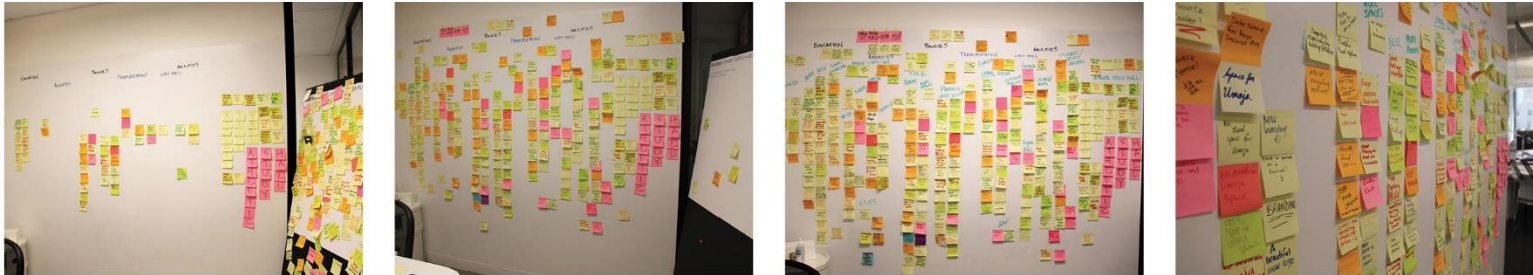

100 IDEAS

Common Themes

STUDENT + CAMPUS LIFE

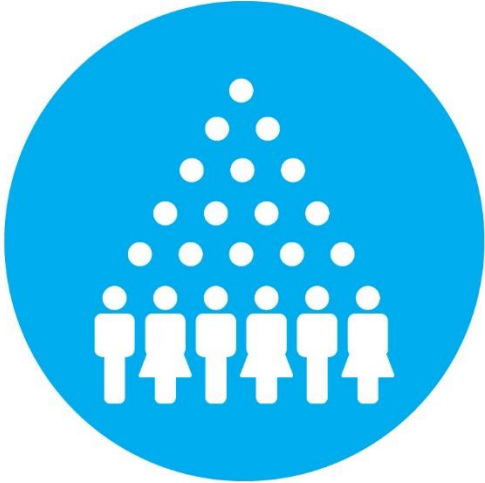

STUDENT SUPPORT



FOOD + HEALTH



OPEN SPACE

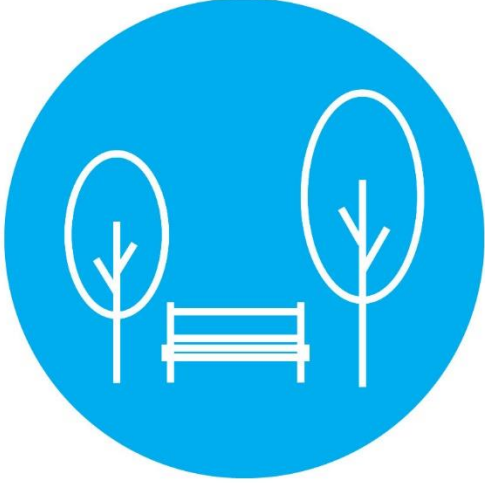

CIRCULATION + PARKING



FACILITIES



ON-LINE SURVEY

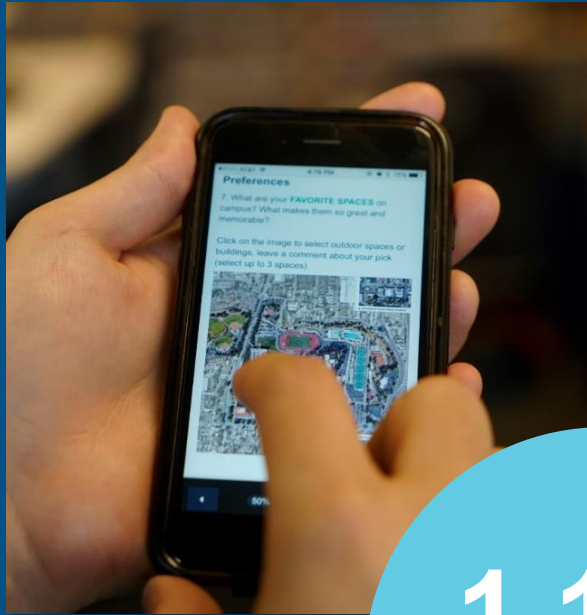

1,187
Completed
Surveys

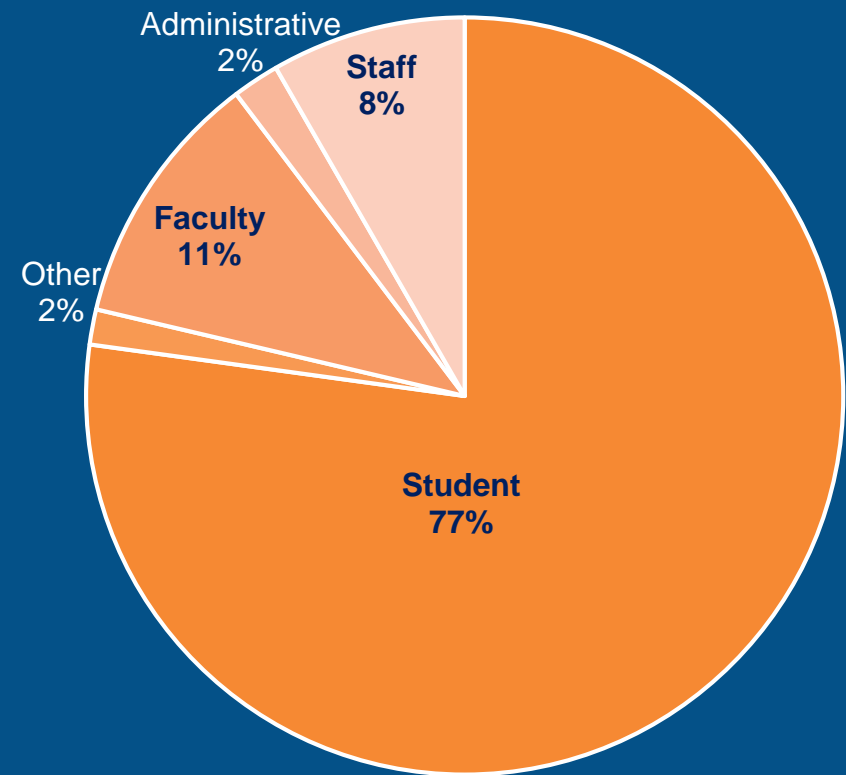

Commuting to Campus

How long is your commute?

Average Commute Time **Students**

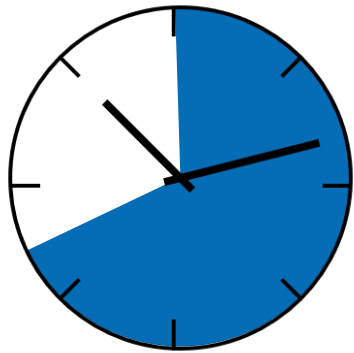

37

Minutes

28% of students self reported a commute time of

> 60 minutes

Average Commute Time **Admin, Faculty & Staff**

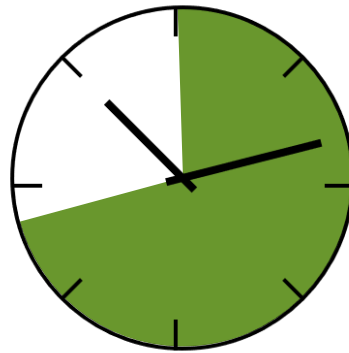

38

Minutes

25% of faculty, staff, and admin self reported a commute time

> 60 minutes

How do you commute?

68%

Drive alone

10%

Are dropped off

9%

Take the bus

7%

Carpool

Favorite Spaces

*“My favorite space is the **library** because I get the quiet space I need to complete my work and the WIFI is stronger if I chose to bring my own laptop or use my phone.”*

*“The **Fine Arts Building** is beautiful and the walkway just outside is a lovely space to enjoy a few minutes of quiet.”*

*“The **LA building** offers beautiful, useful classrooms and offices to faculty, staff, and students. It also set a high standard that is offered to disabled students through the Disabled Students Programs and Services department.”*

*“The **learning center** is one of my favorite spaces because it provides help for classes I struggle with.”*

*“The **outdoor hangout areas** are a nice addition to the campus and they provide a couple outlets to charge phones or computers, so you can be outside and do your homework if you want.”*

Least Favorite Spaces

“The **Health Science building** is the oldest building on this campus. It houses the most programs and yet looks the worst and is the most run down. It's quite sad.”

“The **food selection** is not good at all. I wish there were cleaner options, especially for people who are trying to eat healthy. And save money.”

“**Parking** is awful. It takes forever to find a spot and then it ends up being far away from where my class is.”

“I work in the **adult education** department, and we do not have enough space to support all our students. Our space is not an effective workspace for all of our staff and students.”

“The **Police Department** is a small building that is beat up inside due to overuse. Designed as a temporary ‘10 year building,’ it's long exhausted its time frame for usage.”

SUSTAINABILITY FORUM

170 Participants

89% Students

**11% Faculty, Staff &
Admin**

WHAT IS SUSTAINABILITY

[Being able to] meet the needs of the present, without compromising the ability of future generations to meet their own needs.

UN World Commission on Environment and Development



ACCOMPLISHMENTS AT CERRITOS



- Received over \$895,000 in utility incentives from 2006-2015
- Significantly reduced electricity and natural gas consumption
- Secured over \$1.5 million in state funding from Governor Brown's 2012 Green Job's Initiative
 - Retrofit lights
 - Fine tune building systems
 - Reduce electrical consumption by over 1 million kW
- Reduced natural gas use 38,000 therms by January 2017
 - Saved more than \$200,000 annually

ACCOMPLISHMENTS



- Drought-resistant plants
 - California native species
- Irrigated with reclaimed water - over 95 percent of the landscape and athletic fields
 - Saving more than **30 million gallons of potable water per year**



ACCOMPLISHMENTS

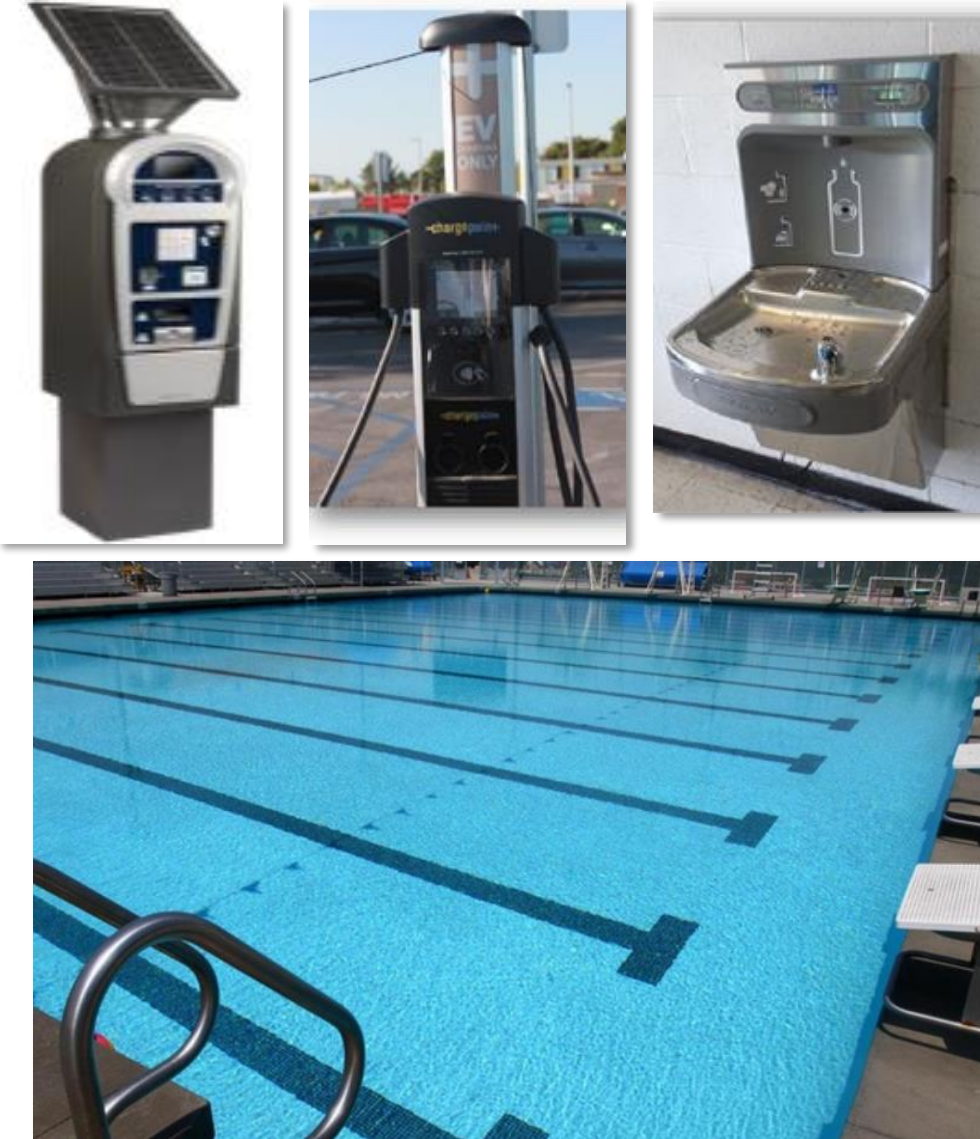

- The campus has nine water hydration stations used in refillable bottles, eliminating over 171,000 plastic bottles as of 2016.
- The campus installed eight public access electric vehicles charging stations eliminating nearly 18,000 pounds of CO2 emissions.
- Parking Permit machines utilize 100% clean renewable solar energy.
- A centralized chilled water plant provides highly efficient cooling and cost savings as compared to individual building equipment.
- Swimming pools are heated through solar which reduces the need for gas heating, saving approximately 17,000 Therms or nearly \$15,000 annually.



WATER

SELECT YOUR TOP TWO PRIORITIES



USE NATIVE/DROUGHT TOLERANT LANDSCAPING

Good landscape design and use of native drought tolerant plants can dramatically reduce the need for irrigation, attract native wildlife and require less fertilizer.

INSTALL ON-SITE GREY WATER/BLACKWATER TREATMENT

Grey water (from sinks) or treated black water (from toilets) can be used for toilet flushing and irrigating plants.

ON-SITE STORMWATER CAPTURE + RELEASE

During a rainstorm, water can be harvested in underground cistern storage and used later for toilet flushing and irrigating plants.

WATER

IMPLEMENT LOW FLOW IRRIGATION SYSTEM

Low-flow irrigation systems operate under a lower water pressure, can be fed by water from rain barrels and uses much less water than a traditional irrigation system.

MAXIMIZE USE OF RECLAIMED WATER

Harvested stormwater can be substituted for potable water in landscape irrigation, fire suppression, toilet and animal flushing, and custodial uses.

CAMPUS WIDE WATER LEAK DETECTION SYSTEM

A detection system finds leaks in the water system that is used for toilets, drains and pipes throughout campus. This helps to maximize the most efficient use of water.

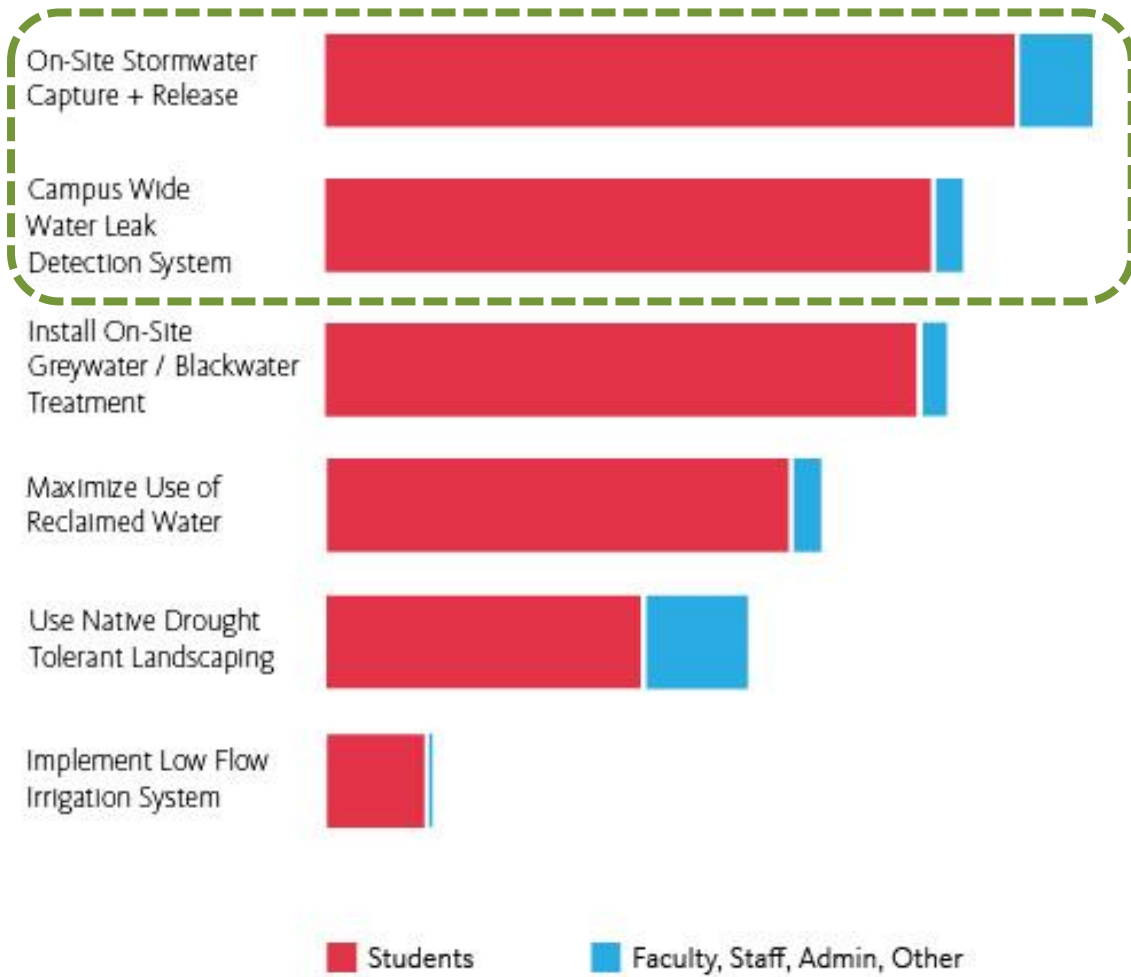

INVEST IN THE FUTURE

Where do you want to see Cerritos College invest in 5 years?

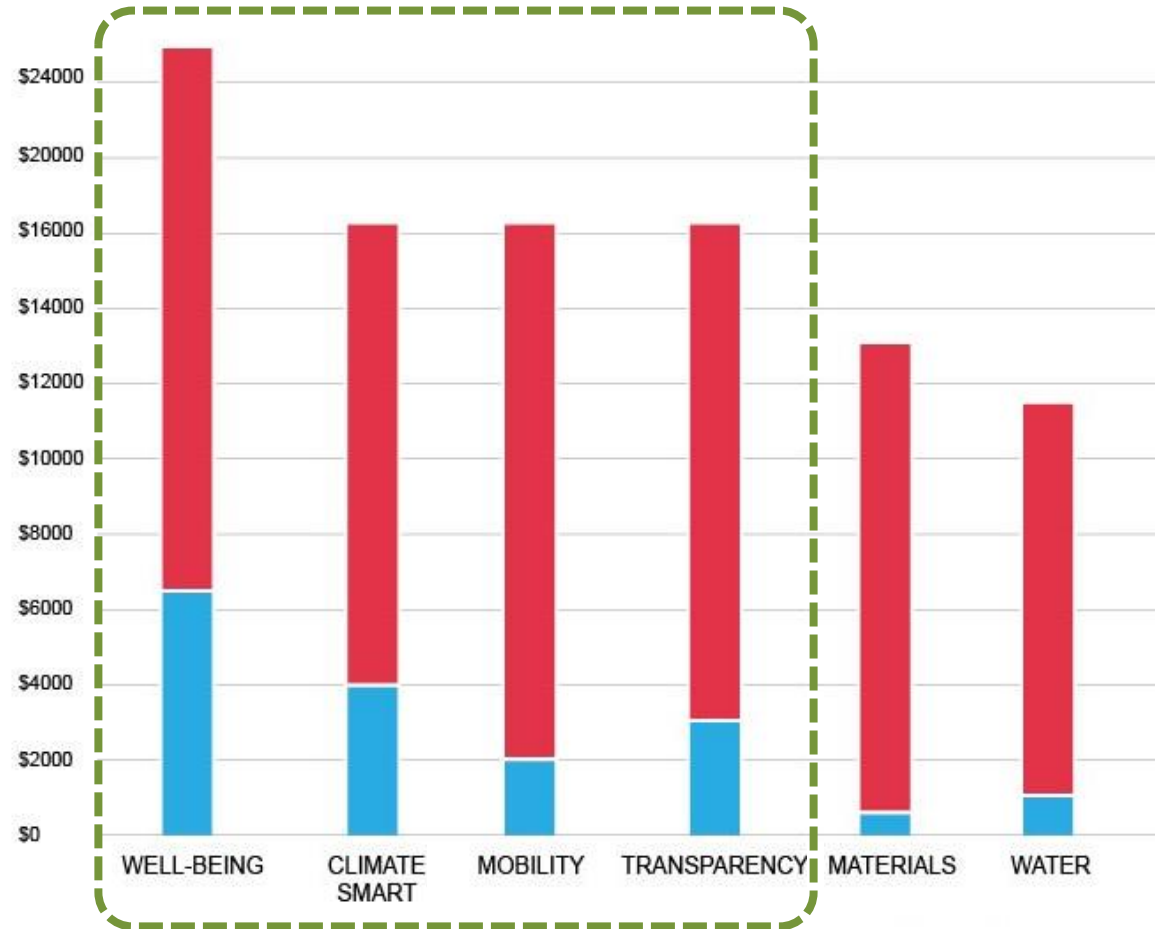
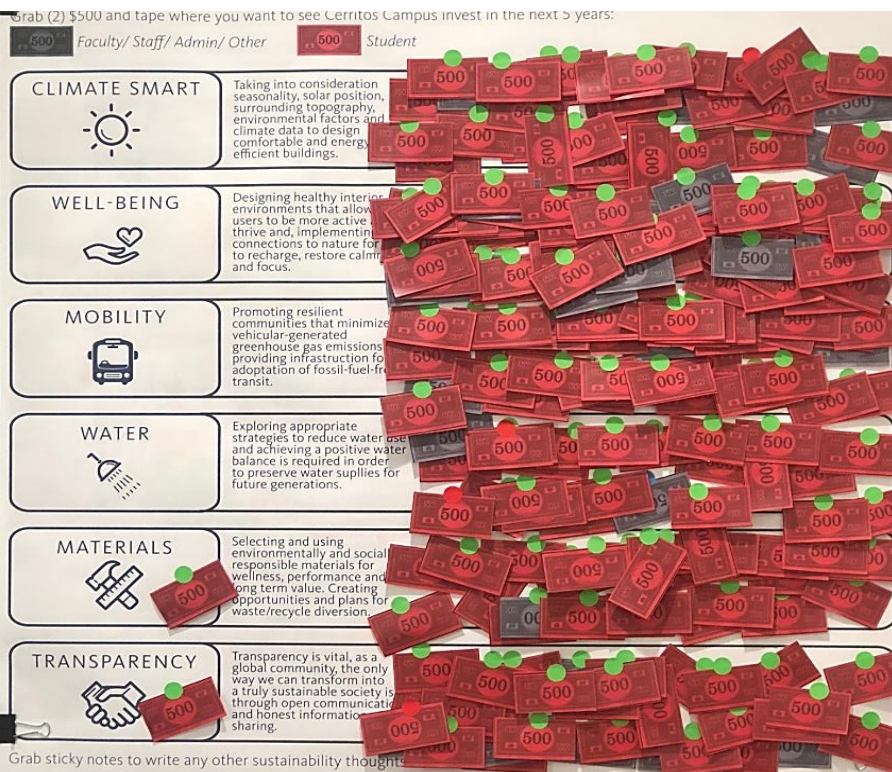



DATA INFORMED

EXISTING CAMPUS



DEVELOPMENT HISTORY

Year Built

- 1950's
- 1960's
- 1970's
- 1980's
- 1990's
- 2000's
- 2010's
- Under Construction

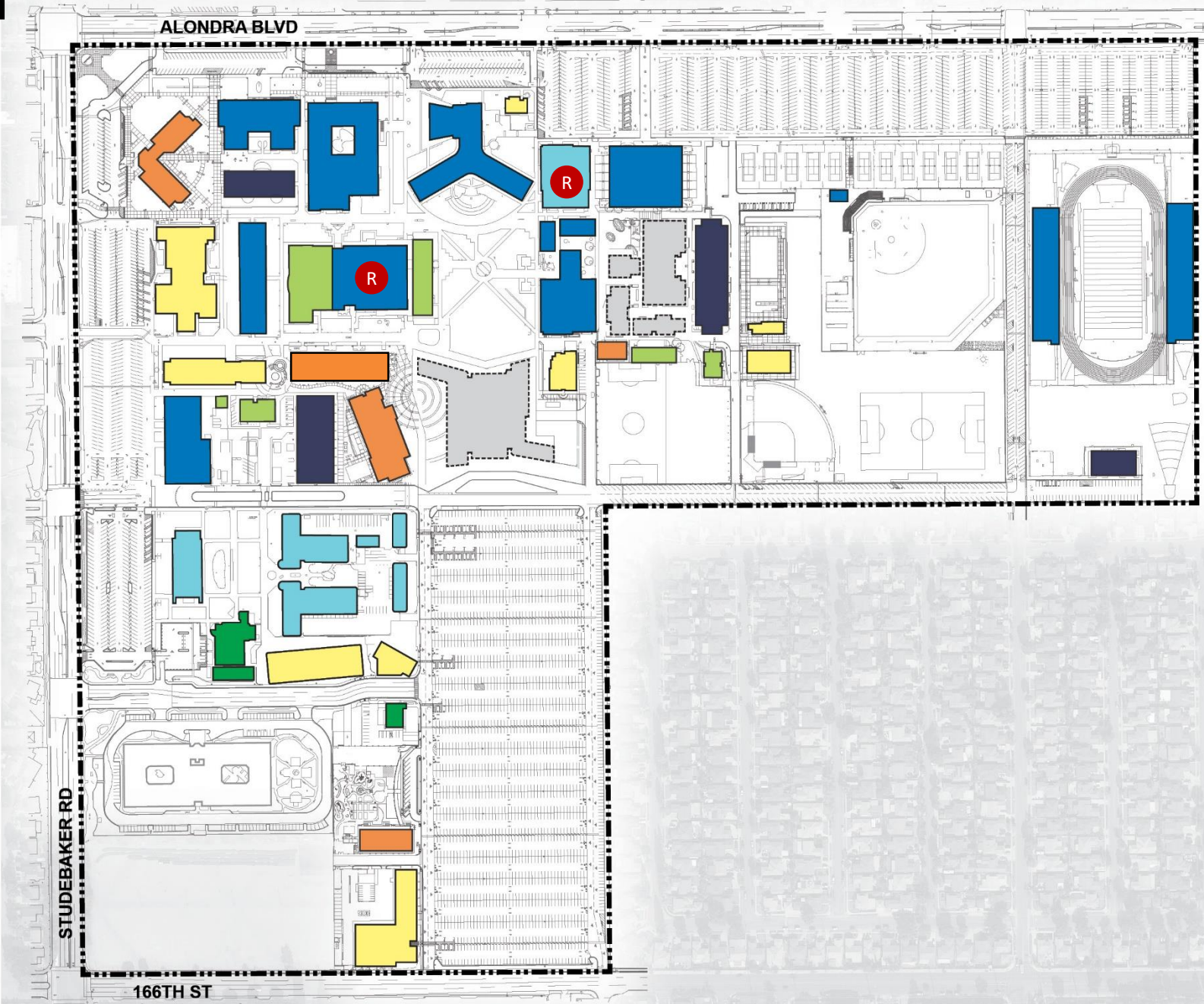

EXISTING BUILDINGS

Facilities

Condition Index

- 0% - 33%
- 34% - 66%
- 67% - 99%
- 100% +





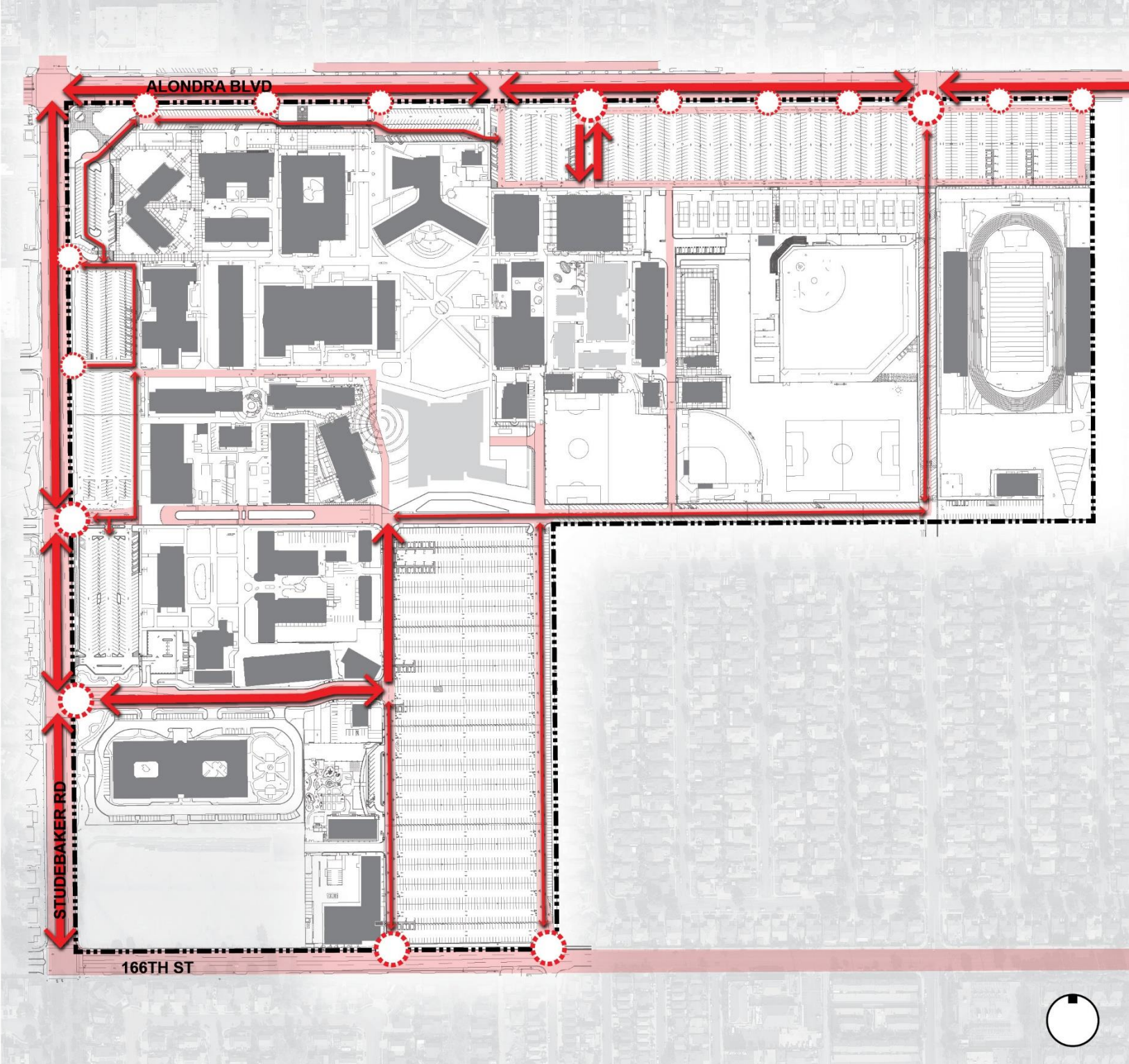

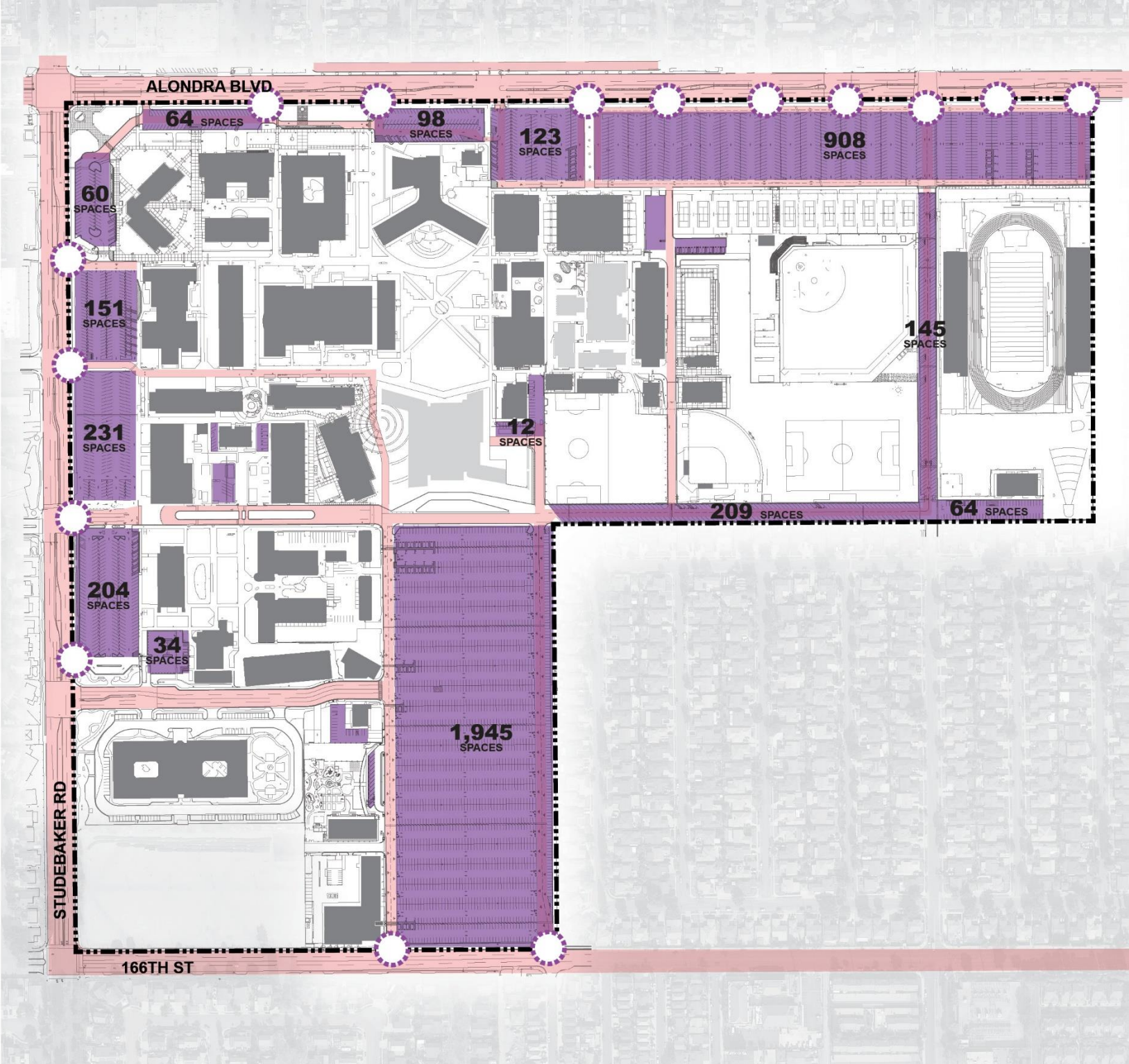

EXISTING VEHICULAR CIRCULATION



EXISTING PARKING







-  Traffic Signal
-  Road
-  Primary Circulation
-  Secondary Circulation
-  Parking Entrance
-  Parking Lot

SPACE ANALYSIS

Room Categories

CAPACITY/LOAD CATEGORIES

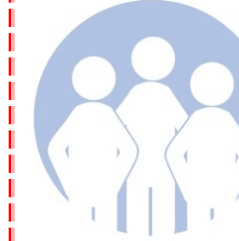
	 LECTURE	 LAB	 OFFICE	 LIBRARY	 INSTRUCTIONAL MEDIA	 OTHER
Room Use Numbers	100s	200s	300s	400s	530s	520, 540 - 800s
Description	Classrooms Support Spaces	Labs Support Spaces	Offices Support Spaces All offices including administrative and student services	Library Study Tutorial Support Spaces	AV/TV Technology Support Spaces	PE Assembly Food Service Lounge Bookstore Meeting Rooms Data Processing Physical Plant Health Service

FMP SPACE PROGRAM (2030)

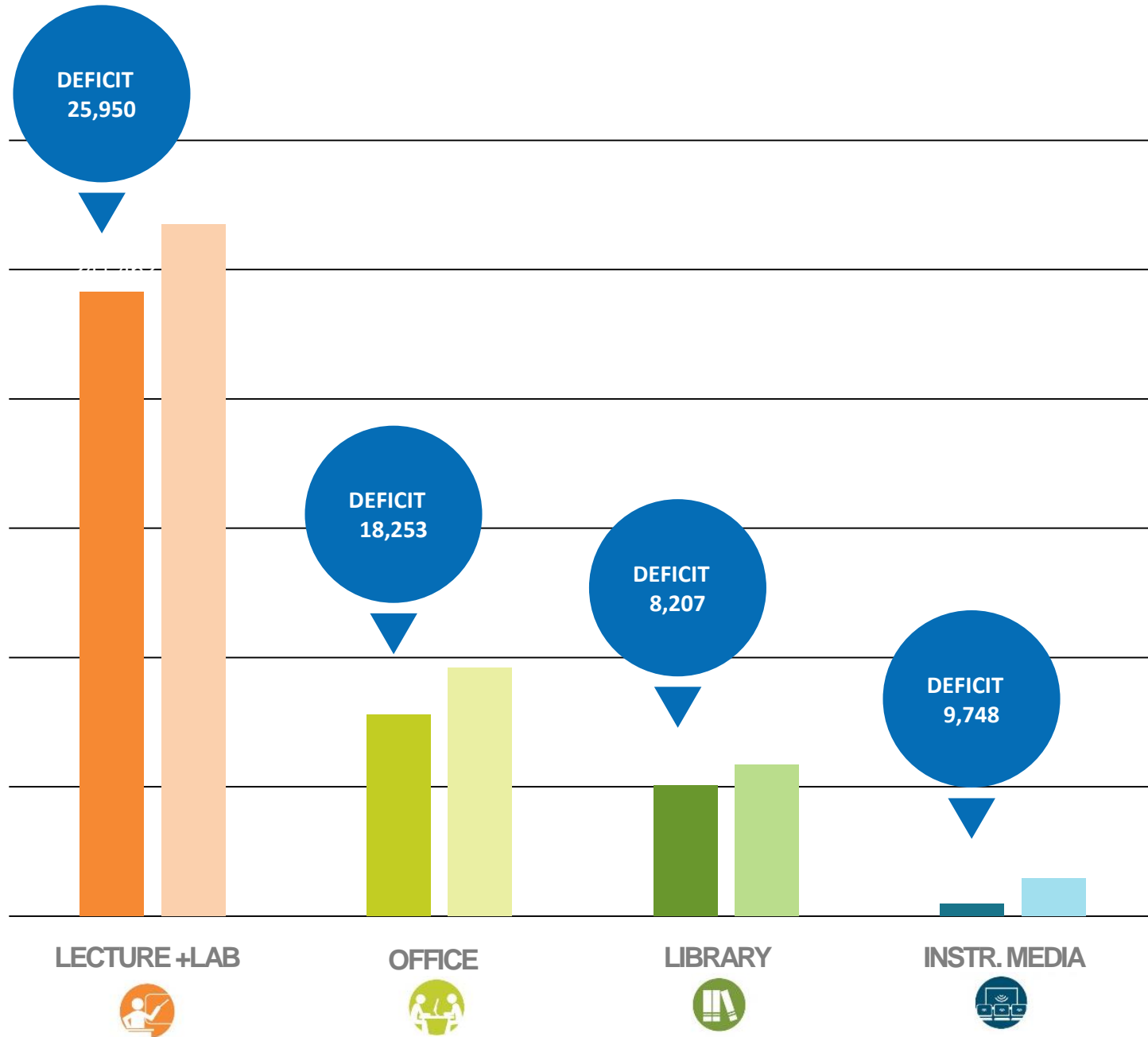



INTEGRATED



Cerritos
College

2017-2023
EDUCATIONAL
MASTER PLAN

GOALS

Linking the EMP to the FMP

PROCESS

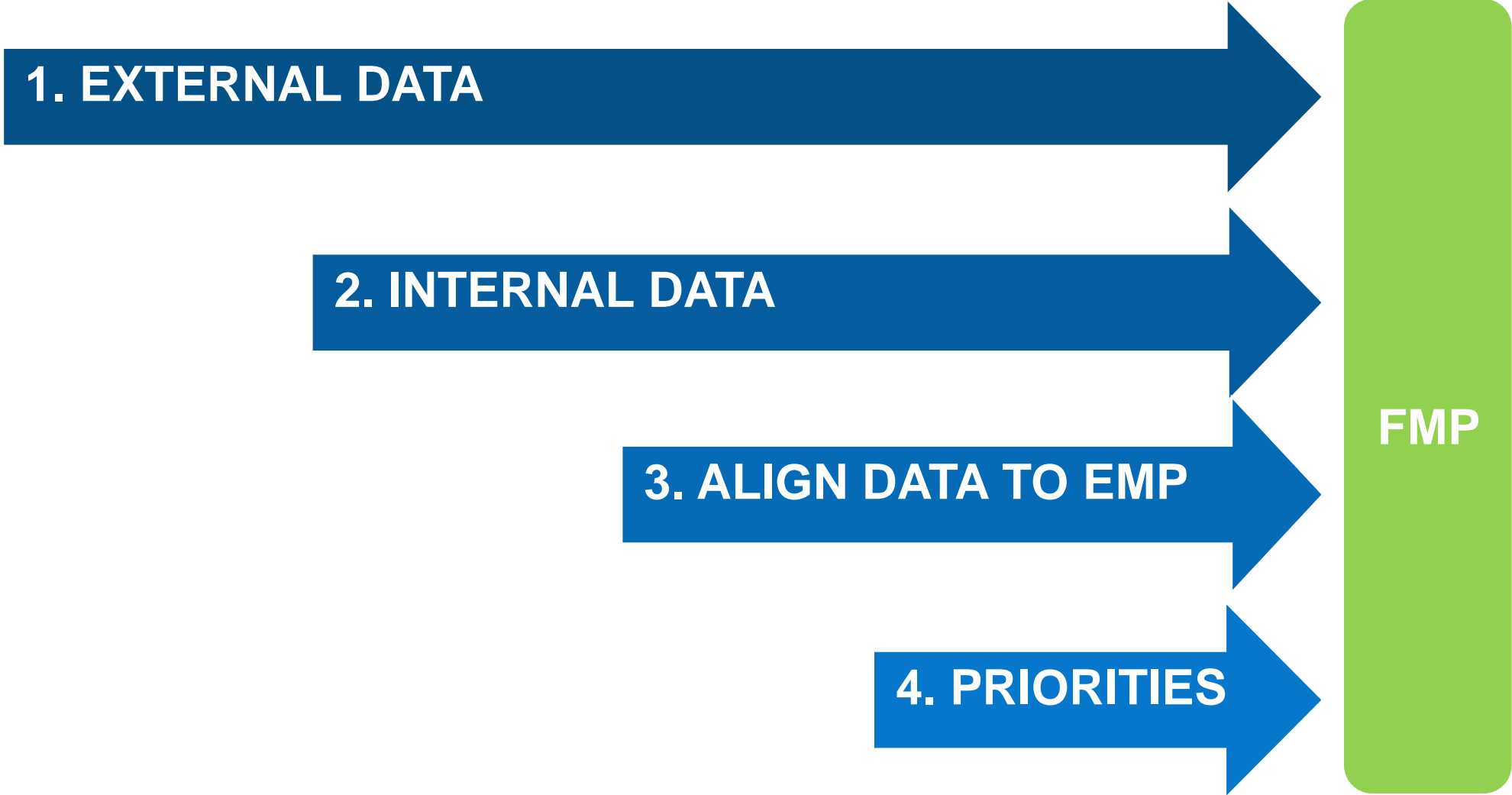

GOAL A

STRENGTHENING THE CULTURE OF COMPLETION

Highlight clear educational and career pathways for ALL students and provide the programs, guidance and support they need to achieve their educational goals in a timely manner.

GOAL B

ENSURING PROGRAM ALIGNMENT BY STRENGTHENING PARTNERSHIPS

Ensure all educational programs are aligned with industry trends and labor market needs. Strengthen partnerships with high schools, universities and strategic business and industry to build a complete pathway to completion.

GOAL C

PROMOTING LEADERSHIP AND STAFF DEVELOPMENT

Develop an organizational culture for all employees that supports professional growth, intra- and inter departmental collaboration, institutional memory, and leadership continuity.

GOAL D

IMPROVING INTERNAL AND EXTERNAL COMMUNICATION

Raise awareness about who we are and convey that message effectively, both internally and externally. Improve information transfer between all our on-campus constituent groups as well as with our external community.

GOAL E

UPGRADING EDUCATIONAL INFRASTRUCTURE

Continue with the modernization of campus buildings and information technology to ensure all facilities and IT systems on campus meet industry standards.

GOAL F

ENHANCING ORGANIZATIONAL EFFECTIVENESS

Enhance organizational effectiveness by streamlining and simplifying College systems and processes. Diversify revenue sources to maximize discretionary funding opportunities.

GOAL A

STRENGTHENING THE CULTURE OF COMPLETION

Highlight clear educational and career pathways for ALL students and provide the programs, guidance and support they need to achieve their educational goals in a timely manner.

GOAL B

ENSURING PROGRAM ALIGNMENT BY STRENGTHENING PARTNERSHIPS

Ensure all educational programs are aligned with industry trends and labor market needs. Strengthen partnerships with high schools, universities and strategic business and industry to build a complete pathway to completion.

GOAL C

PROMOTING LEADERSHIP AND STAFF DEVELOPMENT

Develop an organizational culture for all employees that supports professional growth, intra- and inter departmental collaboration, institutional memory, and leadership continuity.

GOAL D

IMPROVING INTERNAL AND EXTERNAL COMMUNICATION

Raise awareness about who we are and convey that message effectively, both internally and externally. Improve information transfer between all our on-campus constituent groups as well as with our external community.

GOAL E

UPGRADING EDUCATIONAL INFRASTRUCTURE

Continue with the modernization of campus buildings and information technology to ensure all facilities and IT systems on campus meet industry standards.

GOAL F

ENHANCING ORGANIZATIONAL EFFECTIVENESS

Enhance organizational effectiveness by streamlining and simplifying College systems and processes. Diversify revenue sources to maximize discretionary funding opportunities.

100 IDEAS

Common Themes

STUDENT + CAMPUS LIFE

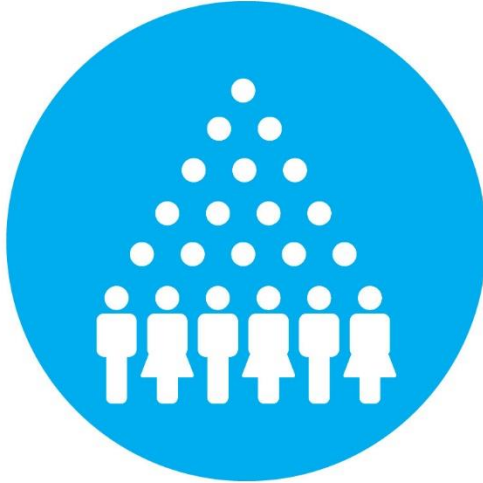

STUDENT SUPPORT



FOOD + HEALTH



OPEN SPACE

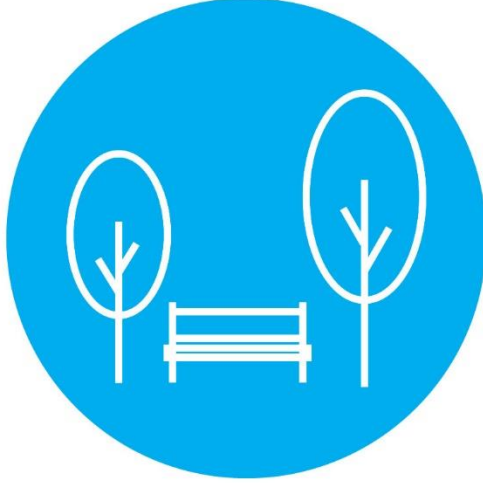

CIRCULATION + PARKING



FACILITIES



FACILITIES PLANNING PRINCIPLES

Student Success

Access + Connectivity

Culture + Identity

Effective + Efficient

**Stewardship of
Resources**

**Community
Engagement**

FACILITIES PLANNING PRINCIPLES

Student Success

- Improve access to programs and services
- Develop pathways to support students' educational goals
- Provide spaces to support studying and collaboration
- Develop campus to enhance student engagement

Access + Connectivity

- Create welcoming + inviting campus entries
- Enhance connectivity + accessibility for all
- Create logical groupings of functions
- Improve connections to all areas of the campus

Culture + Identity

- Develop a welcoming and inclusive campus environment
- Enhance outdoor spaces to support collaboration
- Create a sense of belonging + pride
- Integrate campus development with brand identity

FACILITIES PLANNING PRINCIPLES

Effective + Efficient

- Align facilities to support college priorities
- Replace temporary, inefficient and underperforming facilities
- Right-size facilities to support program needs
- Position to maximize state funding opportunities

Stewardship of Resources

- Optimize available resources
- Maximize land use to align with priorities
- Create a culture of sustainability
- Prioritize well-being, health and comfort in design
- Create a safe and comfortable campus environment

Community Engagement

- Develop campus to enhance community engagement
- Improve campus edges + image within community
- Strengthen connections with surrounding communities
- Improve access to college events and performances

FACILITIES PLANNING PRINCIPLES

Student Success



Access + Connectivity



Culture + Identity



Effective + Efficient



Stewardship of Resources



Community Engagement





DEVELOPMENT CONCEPTS

CANVAS

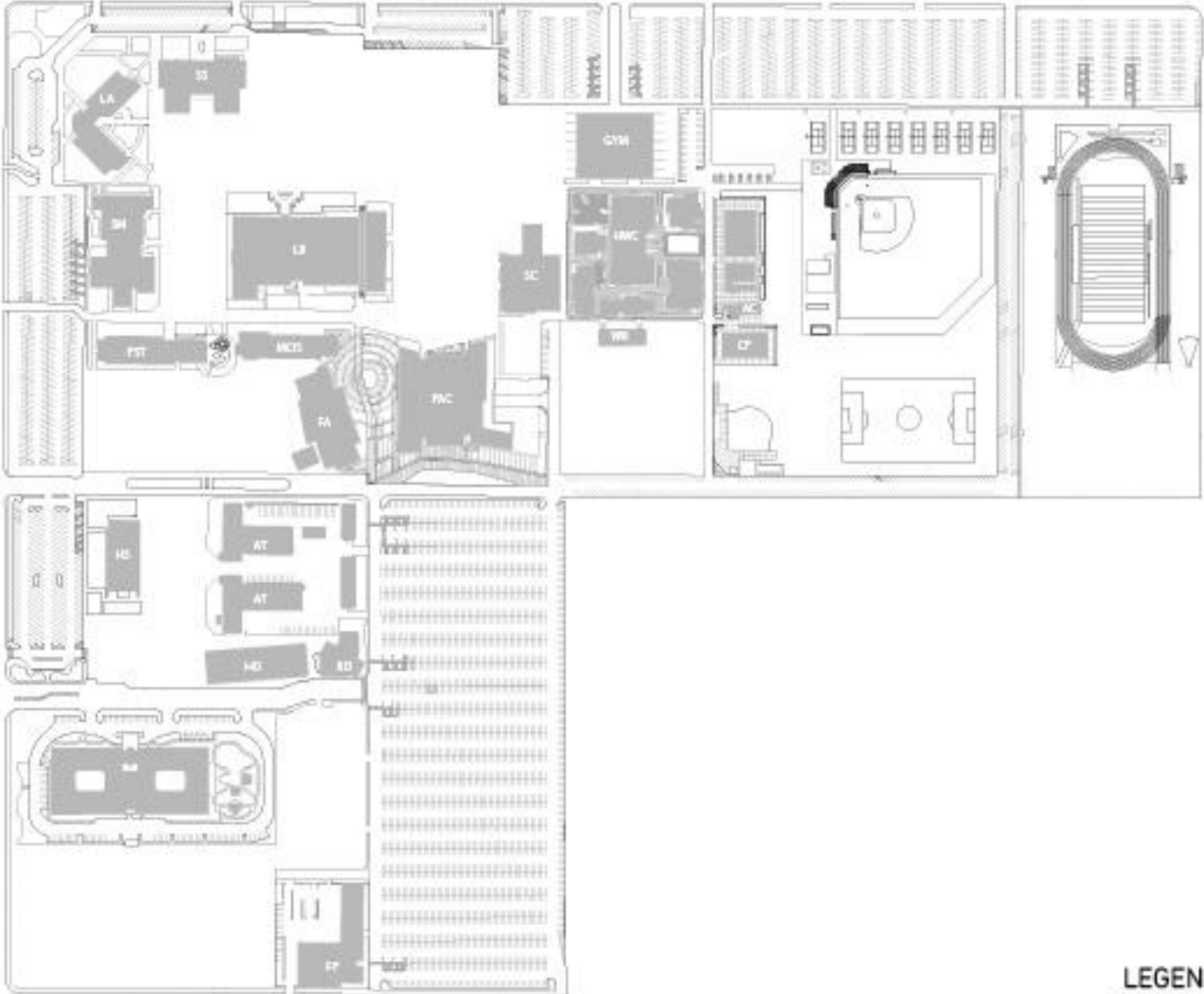

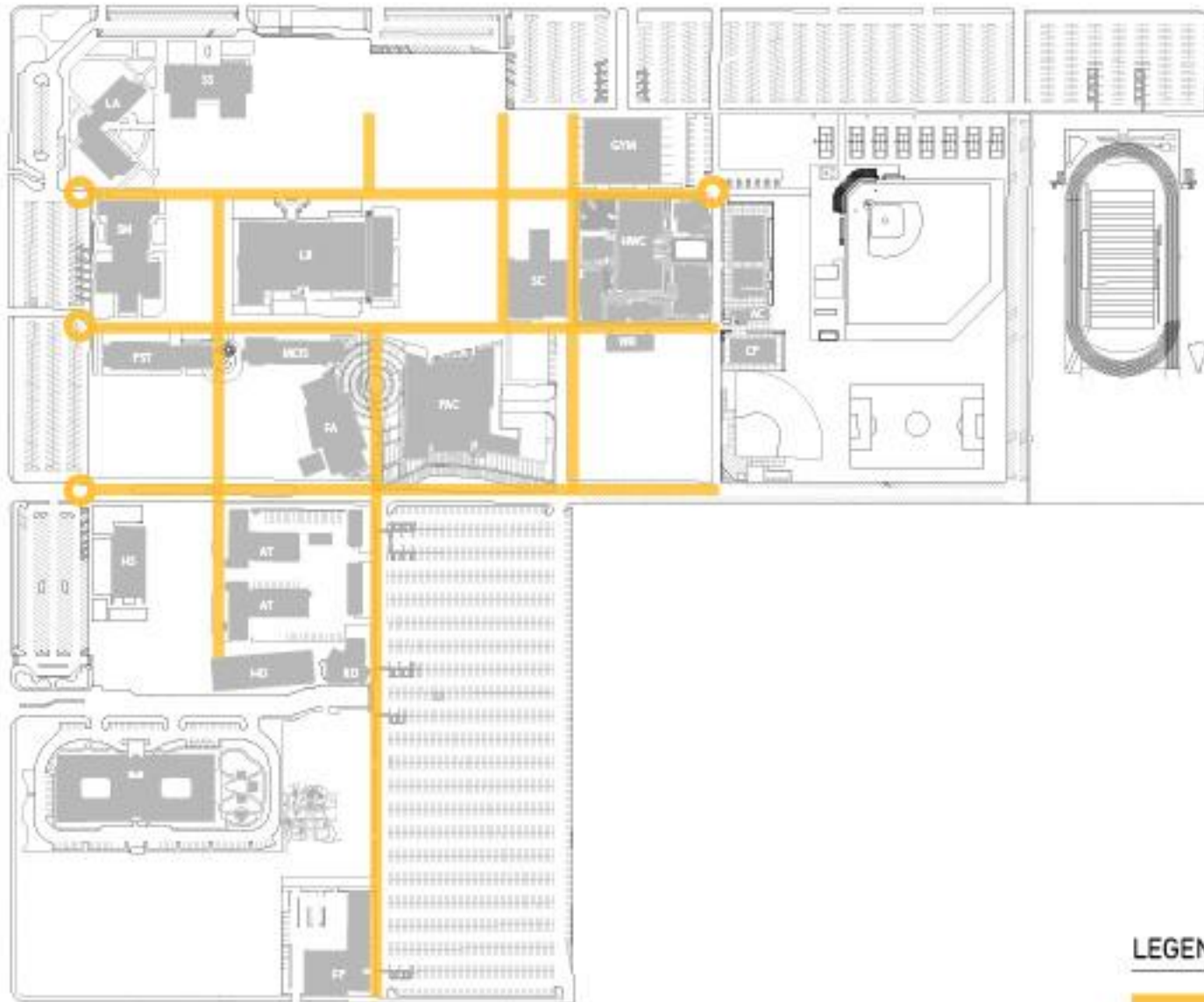

LEGEND
Existing Buildings

PEDESTRIAN CORRIDORS



LEGEND

-  Pathways
-  Existing Buildings

NEW FACILITIES



LEGEND

-  New Buildings
-  Pathways
-  Existing Buildings

VEHICULAR DROP-OFFS



- LEGEND**
- Access Points
 - Vehicular Pathways
 - New Buildings
 - Pathways
 - Existing Buildings

OPEN SPACES



- LEGEND**
- Green Spaces
 - Access Points
 - Vehicular Pathways
 - New Buildings
 - Pathways
 - Existing Buildings

PARKING



LEGEND

-  Parking
-  Green Spaces
-  Access Points
-  Vehicular Pathways
-  New Buildings
-  Pathways
-  Existing Buildings

RECOMMENDATIONS



YOU'RE INVITED!
Stop by the
Campus Planning Session
for the
New Facilities Master Plan

Thursday
May 26
11 a.m. - 12:30 p.m.
12:30 p.m. - 2 p.m.

BASED UPON THE 2016 FACILITIES ASSESSMENT

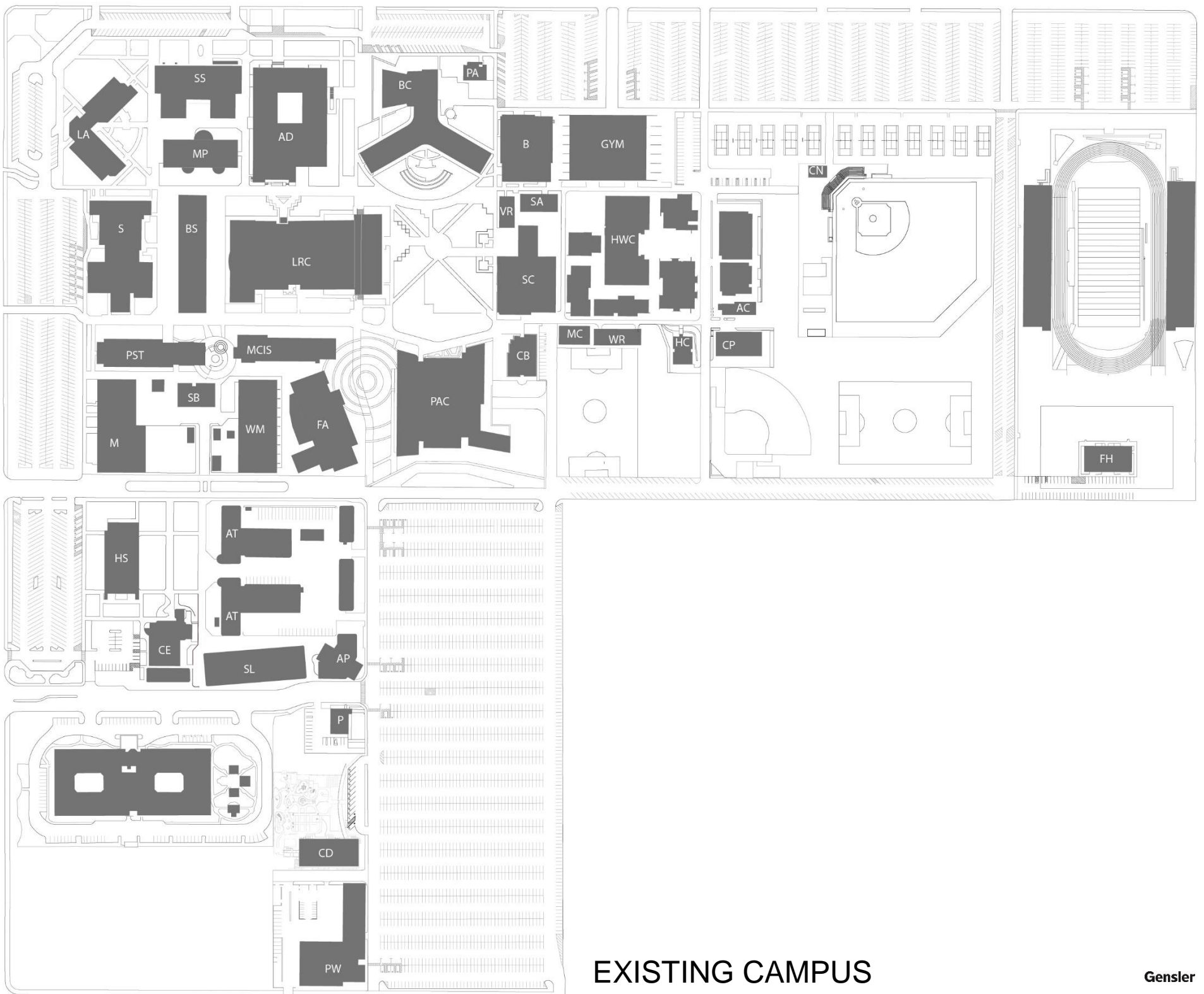

EXISTING CAMPUS



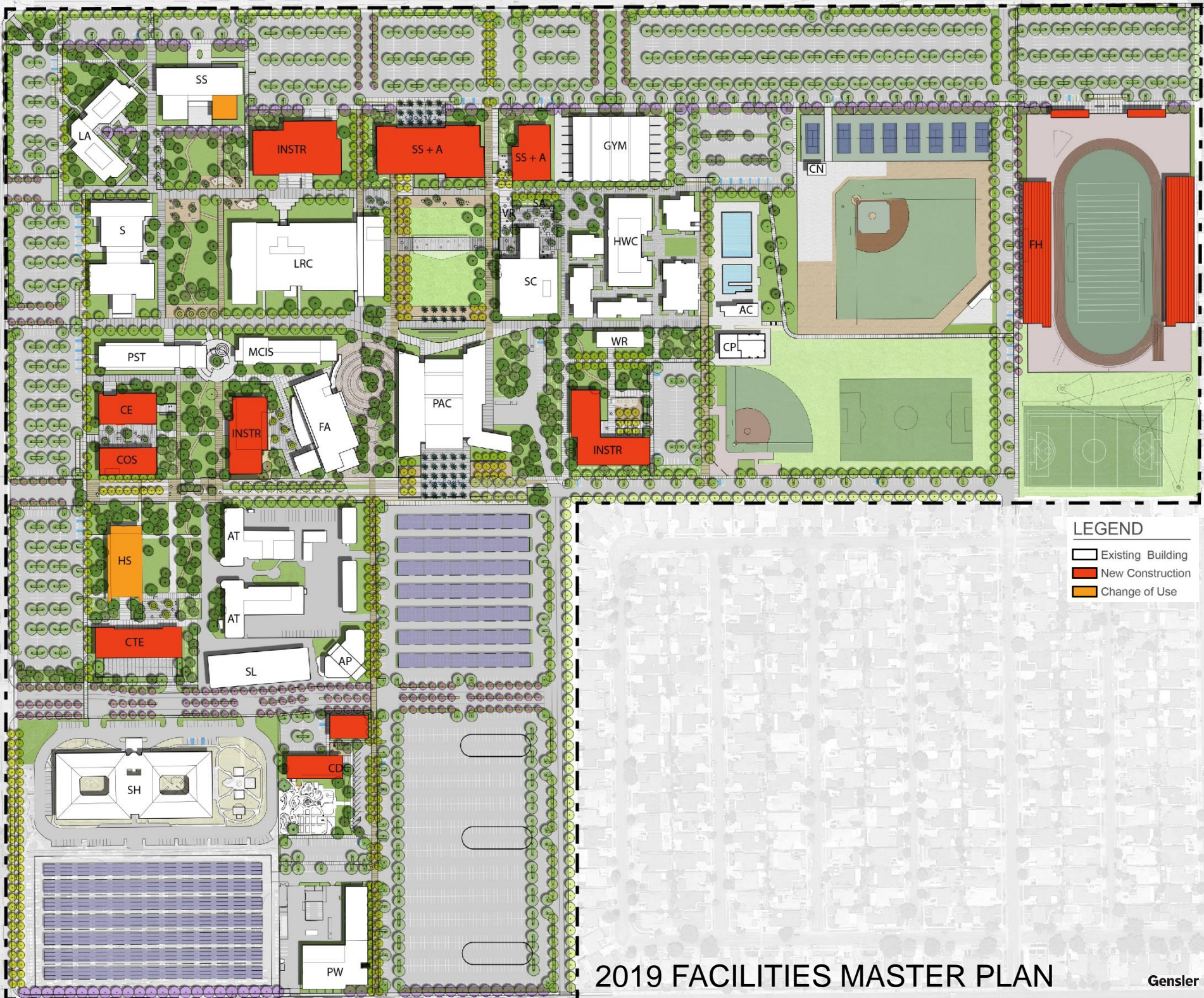

LEGEND

- Existing Building
- New Construction
- Change of Use

2019 FACILITIES MASTER PLAN

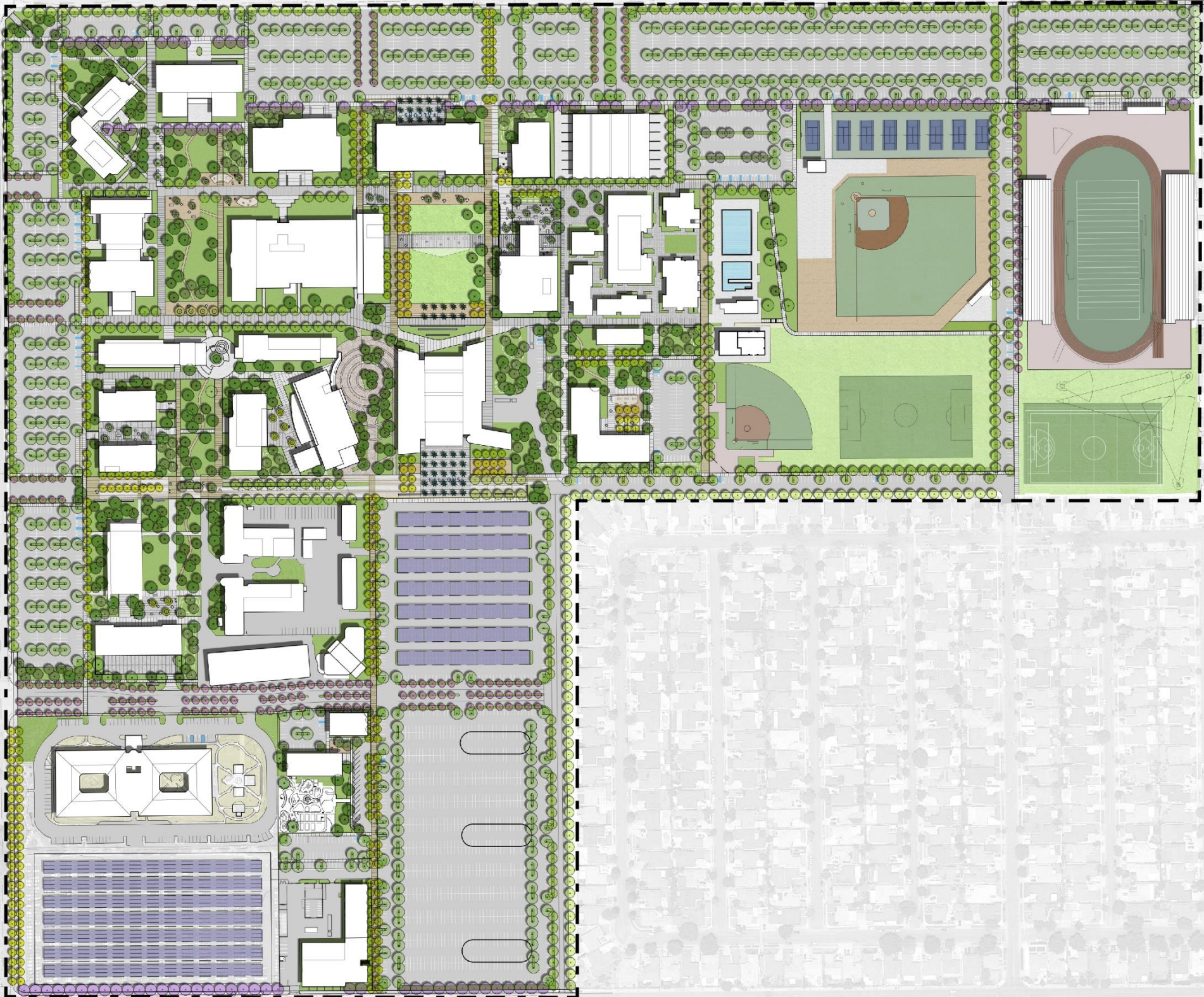

**NEW FRONT
DOOR**

**HEART
OF
CAMPUS**

FALCON WALK

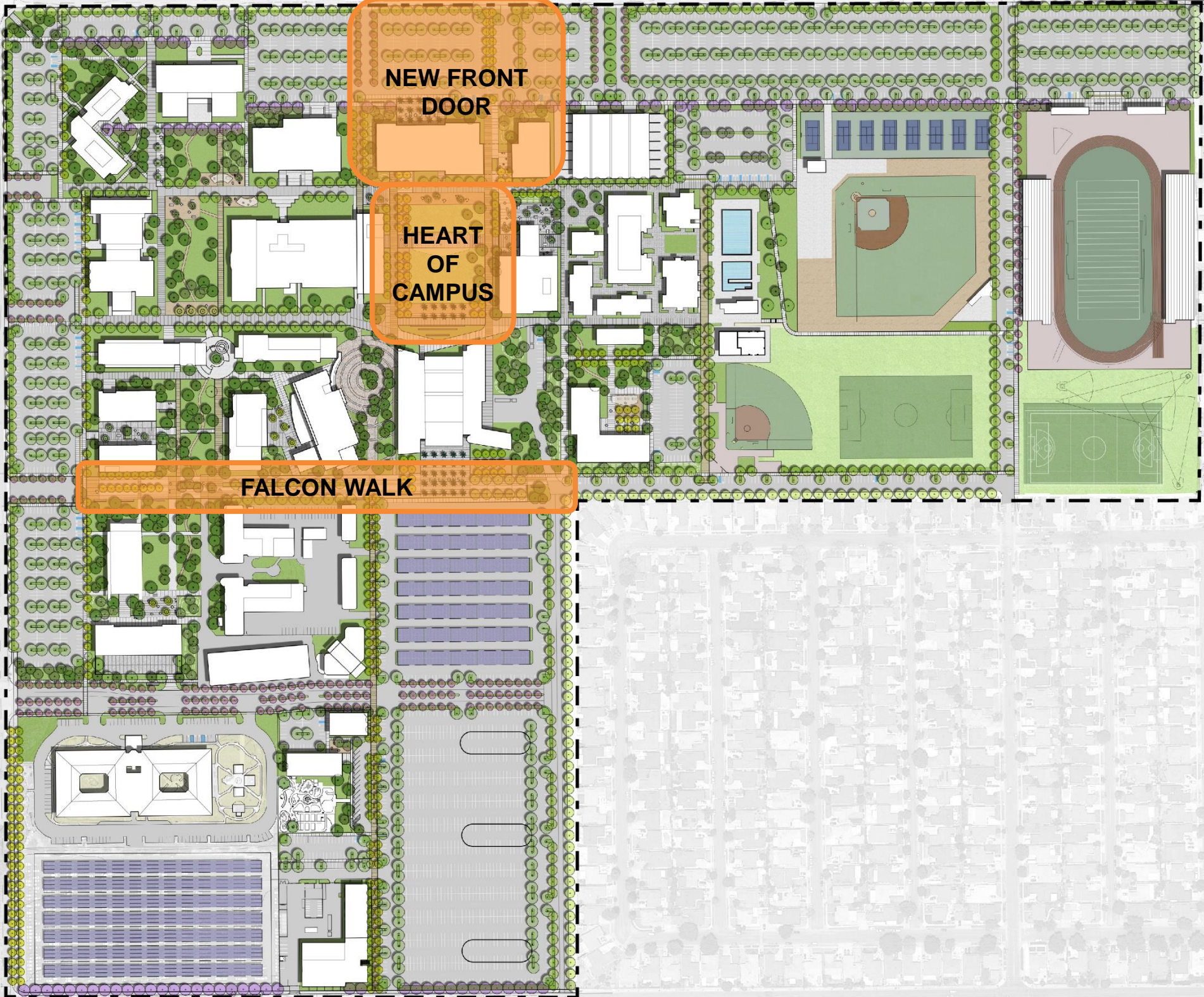



New Front Door

- Welcoming + Inviting
- Sense of Arrival
- Showcases Brand

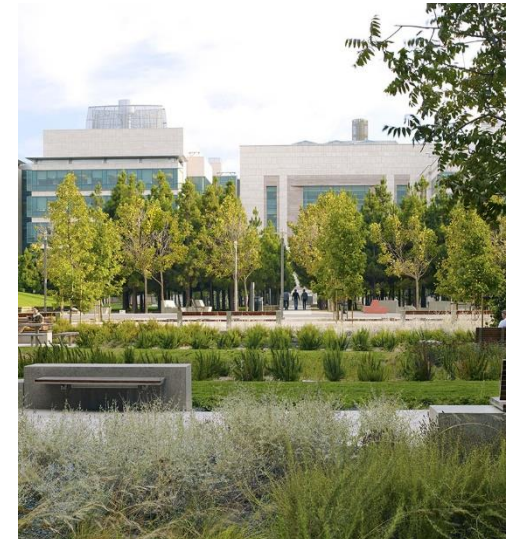



Heart of Campus

- Engagement + Collaboration
- Welcoming + Inclusive
- Sense of Pride





Falcon Walk

- Improved Access
- Enhanced Connectivity
- Safe / Comfortable Circulation

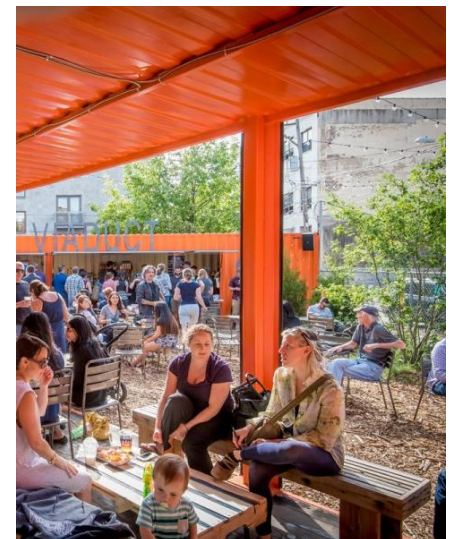

IMPLEMENTATION STRATEGY

CONSIDERATION FACTORS

- Logical movement of functions
- Limited number of moves
- Reduce need for swing space
- Limit campus disruption
- Maximize state funding opportunities







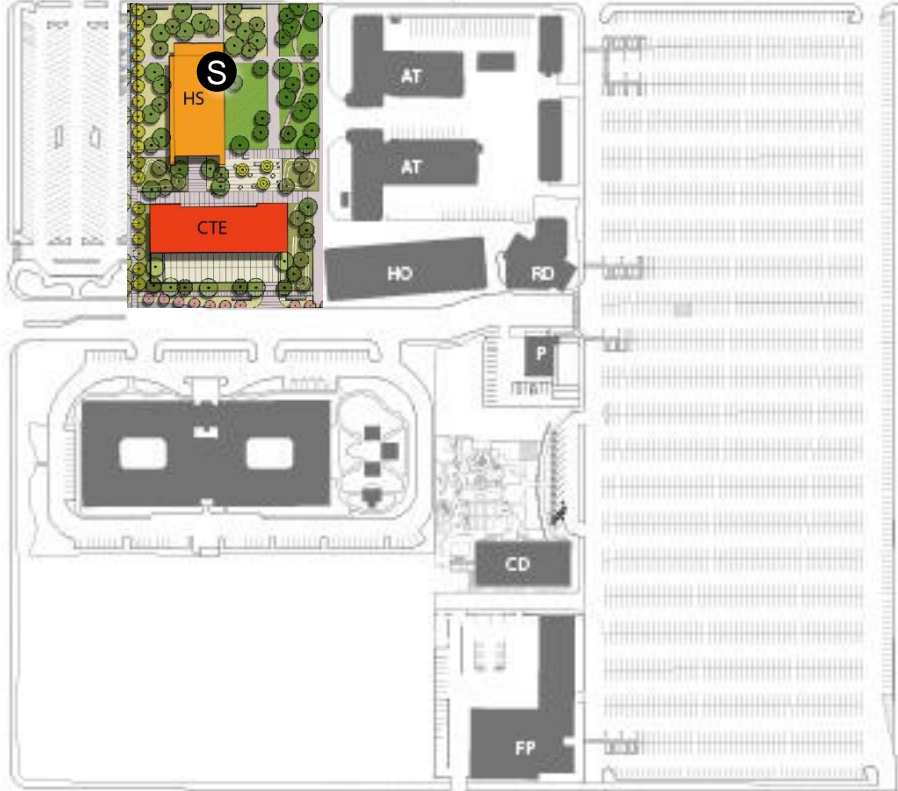







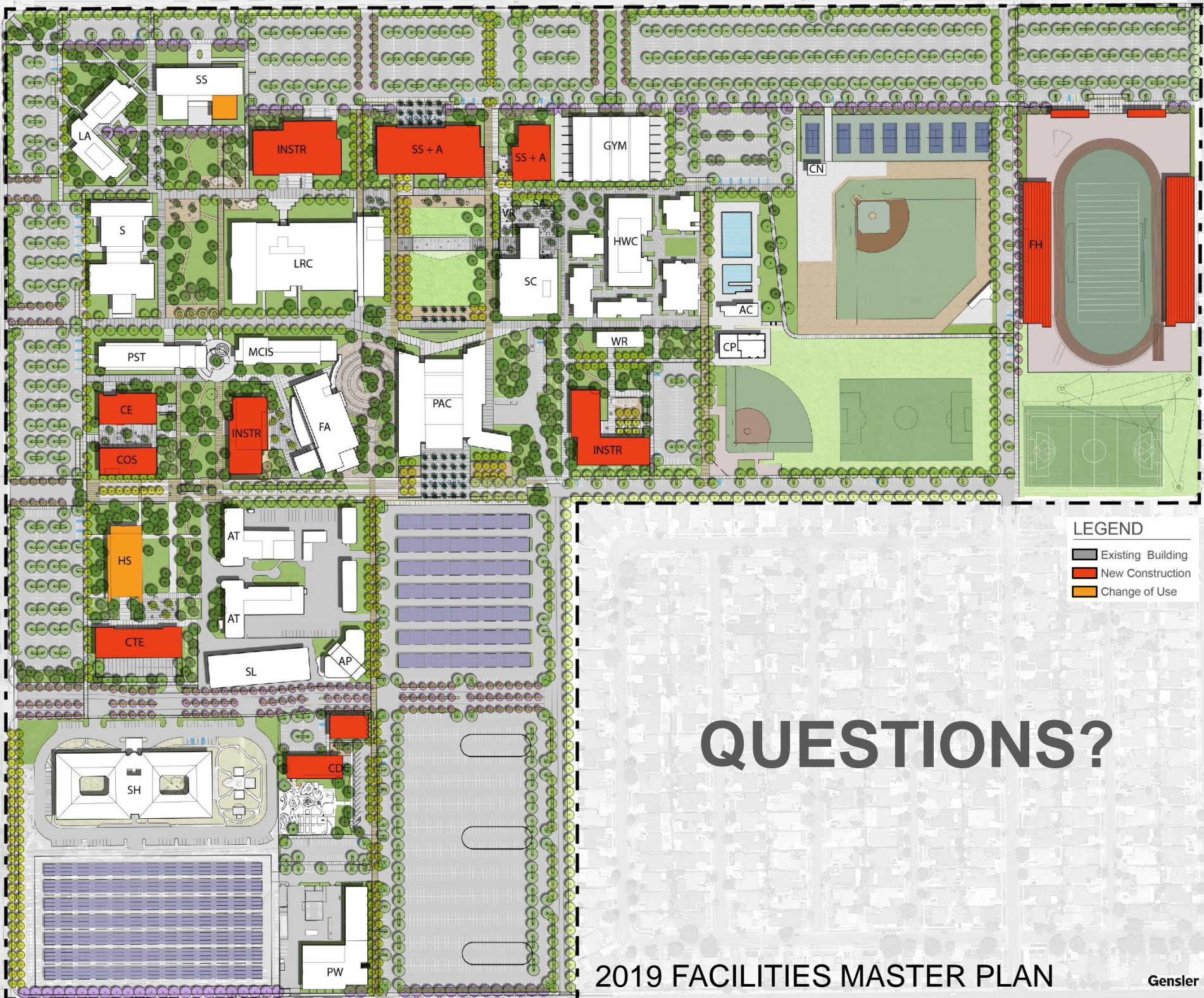

LEGEND

- Existing Building
- New Construction
- Change of Use

QUESTIONS?

NEXT STEPS

Facilities Planning Comm	April 16
Academic Senate	April 23
Board Retreat Session	April 24
Board Approval	May 15